



GREENSKY MECHANICAL



NMRV WORM REDUCER

NMRV蜗杆减速机

杭州绿天新能源科技有限公司
Greensky Power Company Limited



GREENSKY MECHANICAL

杭州绿天新能源科技有限公司
Greensky Power Company Limited

ADD: 1870 Binsheng Rd, Hangzhou, Zhejiang, China

TEL: +86-571-8819 5488

FAX: +86-571-8819 4366

Zip Code: 310052

Email: info@greensky-power.com

Web: www.greensky-power.com

www.gsp-mech.com

绿天机械 绿天新能源的一个机电品牌

GREENSKY MECHANICAL
AN ELECTROMECHANICAL BRAND OF GREENSKY POWER

15年机电生产和销售经验

15 YEARS EXPERIENCE IN ELECTROMECHANIC PRODUCTION AND SALE

“一次即永久”的质量原则

“ONCE AND FOREVER” QUALITY PRINCIPAL

中德领先品牌

A SINO-GERMAN LEADING BRAND

绿天机械是杭州绿天新能源科技有限公司下属的高端机电品牌。公司提供蜗杆减速机、齿轮减速机、交流电机、直流电机、控制器等产品以及研发定制服务。公司旗下有控股的减速机和电机工厂并与多个工厂有品牌代工合作，以满足客户一站式的高品质电机供应服务。公司拥有多名10年以上电机行业工作经验的电机与驱动工程师以及 德语、日语、英语多语种销售团队，通过强大的技术团队和现代化的采购质检系统，绿天提供高品质低成本的机械产品，专业快捷的服务到世界各地，与客户实现共赢。

Greensky Mechanical is a premier motor brand of Greensky Power Co., Ltd. The company provides worm reducer, gear reducer, AC & DC motor, controller and customized R&D products. Connecting our own factories with the cooperative OEM factories, we offer one-stop high quality motor sourcing service to our customers. Our team consists of excellent experienced motor & drive experts and professional sales managers serving German, Japanese, English and other common languages. With our professional technical support, modern quality management system and lean operation approach, Greensky delivers high quality mechanical products with efficient service to customers all over the world.

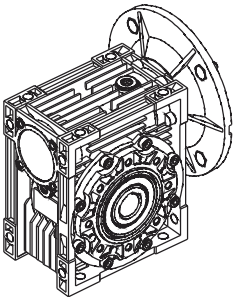
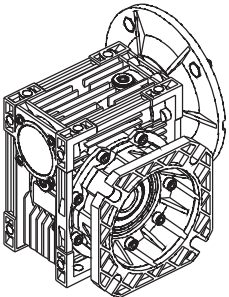
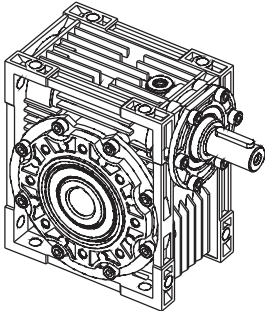
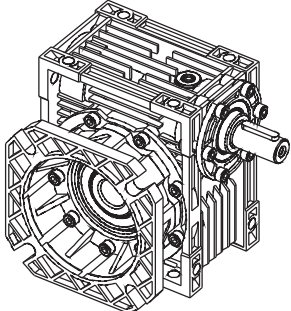
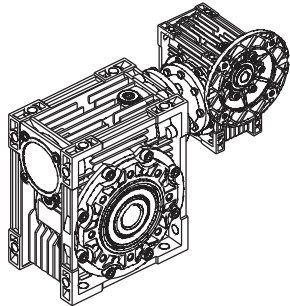
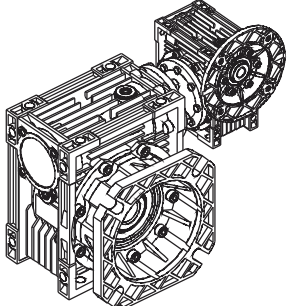
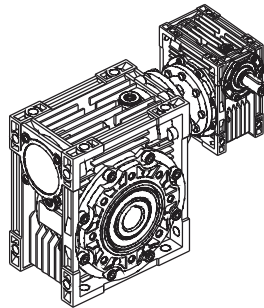
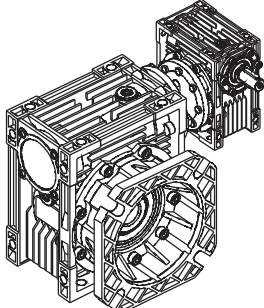

蜗轮减速机型号 Versions

	NMRV 025-130	NMRV 025-130 F	
	NRV 025-130	NRV 025-130 F	
	NMRV-NMRV 025-130	NMRV-NMRV 025-130 F	
	NRV-NMRV 025-130	NRV-NMRV 025-130 F	



NMRV/NRV

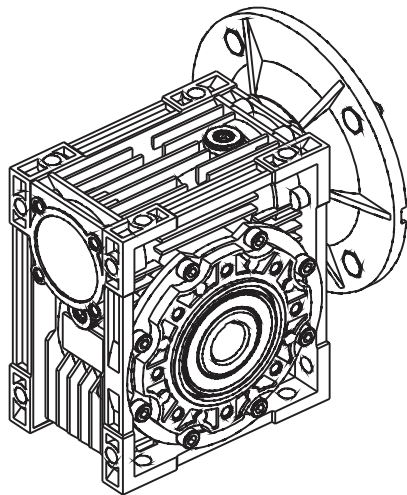

NMRV

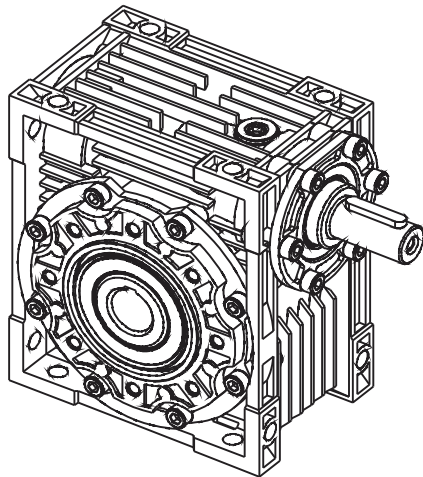

NRV

NMRV型号标记 NMRV Model & marker

NMRV-063-30-VS-F1(FA)-AS-80B5-0.75kW-B3	
NMRV	蜗轮减速机 Worm geared motor
NRV	蜗轮减速机 (配接输入轴) Worm reduction unit
063	蜗轮减速机中心距 Center distance
30	减速比 Reduction ratio
VS	双向输入轴 Double input shaft
AS	单向输出轴 Single output shaft
PAM	电机联接 Fitted for motor coupling
0.75kW	电机功率 Electric motor power
F1(FA)	输出法兰位置及型号 Output flange
AB	双向输出轴 Double output shaft
80B5	电机机座号和安装结构形式 Motor mounting facility
B3	安装方位 Mounting position



马达直联尺寸 Predisposition

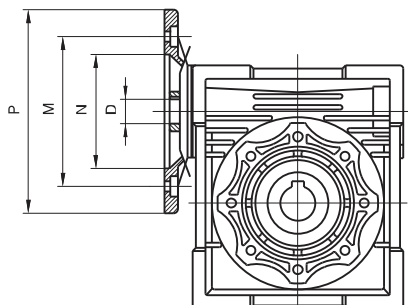

NMRV	PAM	N	M	P	D											
	IEC				5	7.5	10	15	20	25	30	40	50	60	80	100
025	56B14	50	65	80	9	9	9	9	9	—	9	9	9	9	—	—
030	63B5	95	115	140	11	11	11	11	11	11	11	11	11	—	—	—
	63B14	60	75	90												
	56B5	80	100	120												
	56B14	50	65	80												
040	71B5	110	130	160	14	14	14	14	14	14	14	14	—	—	—	—
	71B14	70	85	105												
	63B5	95	115	140												
	63B14	60	75	90												
	56B5	80	100	120												
050	80B5	130	165	200	19	19	19	19	19	19	19	—	—	—	—	—
	80B14	80	100	120												
	71B5	110	130	160												
	71B14	70	85	105												
	63B5	95	115	140												
063	90B5	130	165	200	24	24	24	24	24	24	24	—	—	—	—	—
	90B14	95	115	140												
	80B5	130	165	200												
	80B14	80	100	120												
	71B5	110	130	160												
	71B14	70	85	105												
075	100/112B5	180	215	250	28	28	28	—	—	—	—	—	—	—	—	—
	100/112B14	110	130	160												
	90B5	130	165	200												
	90B14	95	115	140												
	80B5	130	165	200												
	80B14	80	100	120												
090	71B5	110	130	160	—	—	—	—	—	—	—	—	—	—	—	—
	100/112B5	180	215	250												
	100/112B14	110	130	160												
	90B5	130	165	200												
	90B14	95	115	140												
	80B5	130	165	200												
110	80B14	80	100	120	—	—	—	—	—	—	—	—	—	—	—	—
	132B5	230	265	300												
	100/112B5	180	215	250												
	90B5	130	165	200												
130	80B5	130	165	200	—	—	—	—	—	—	—	—	—	—	—	—
	132B5	230	265	300												
	100/112B5	180	215	250												
	90B5	130	165	200												



安装方位 Mounting Positions

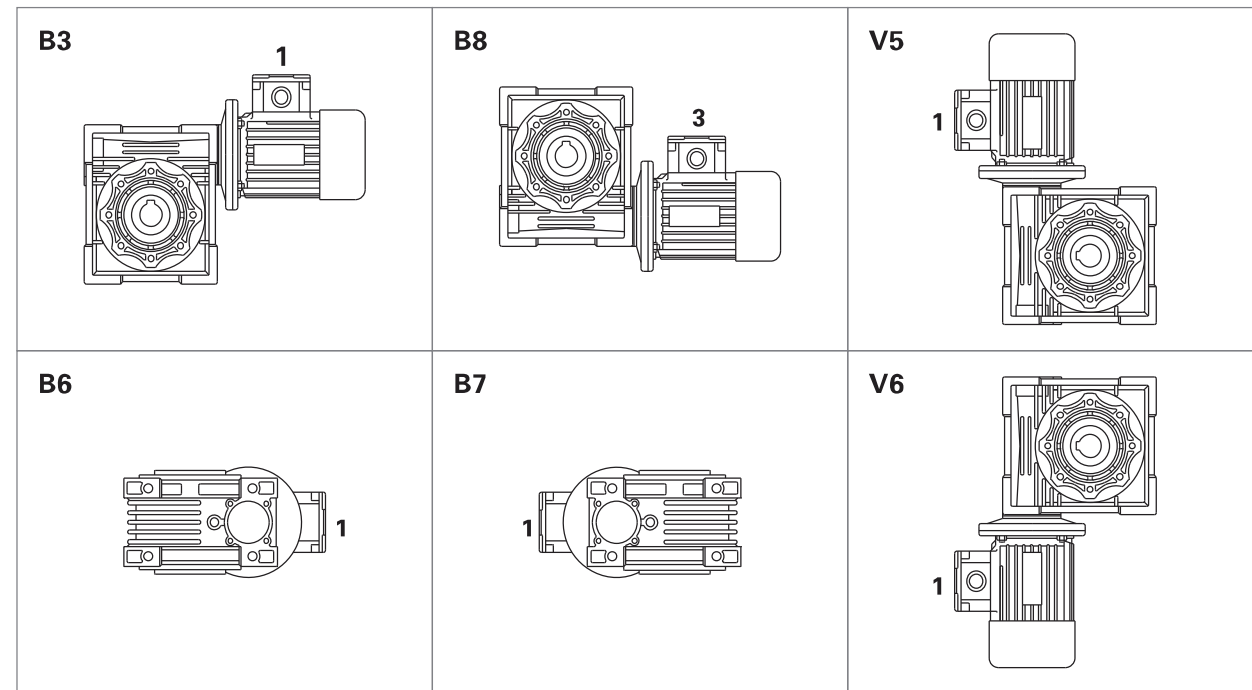

法兰位置 Flange F-FL

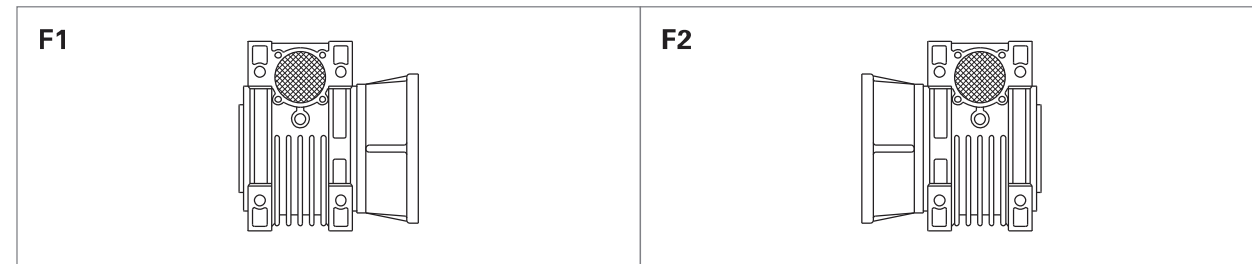

接线盒安装方式 Position of terminal box

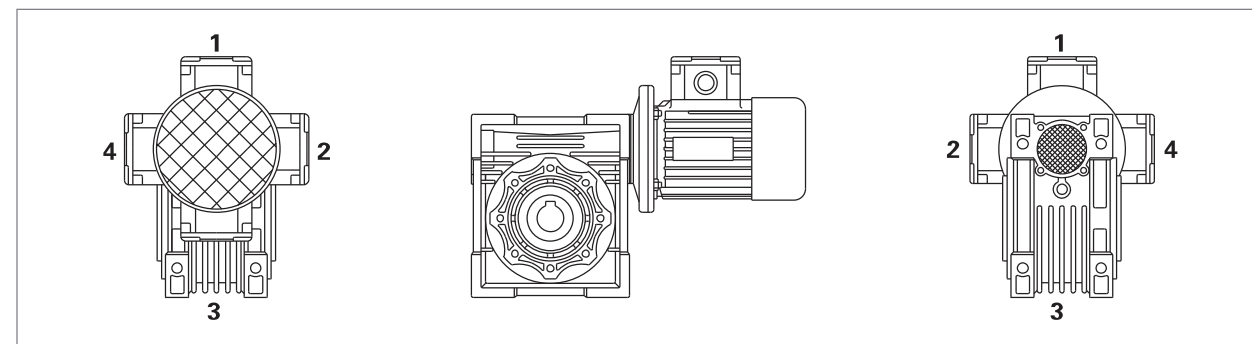



输出轴配置 Position of output shaft

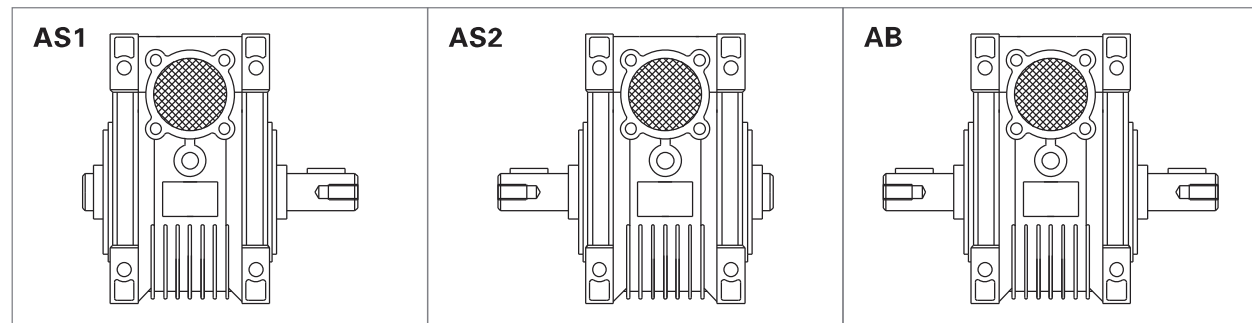

双向输入轴 Double extension worm shaft

扭力臂配置 Position of torque arm

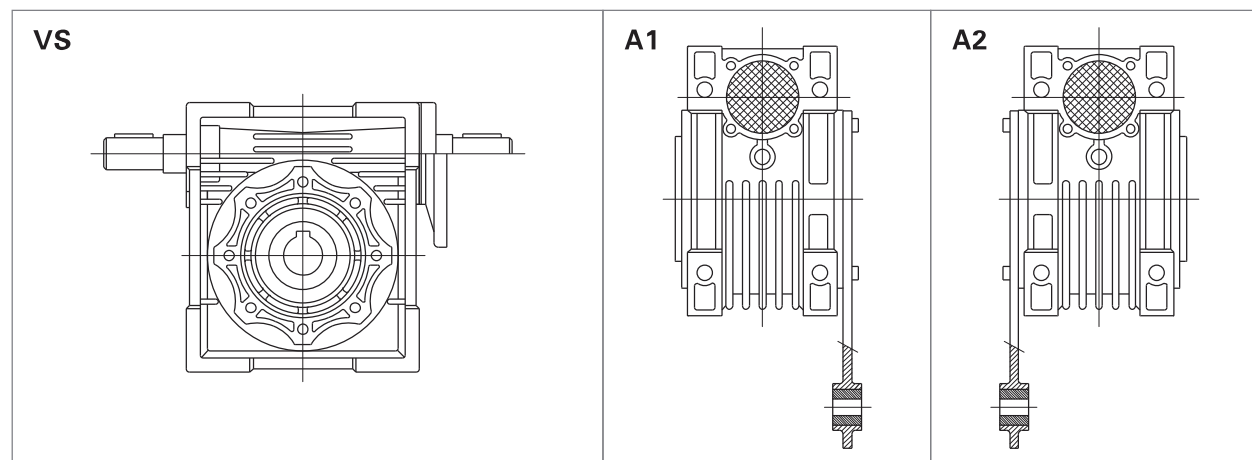

润滑油的选用 Choice of lubeicant

油量公升数 Q.ty of oil in litres									
NMRV	025	030	040	050	063	075	090	110	130
B3	0.02	0.04	0.08	0.15	0.3	0.55	1	3	4.5
B8								2.2	3.3
B6-B7								2.5	3.5
V5								3	4.5

		合成油 Synthetic	矿物油 Mineral
ISO	VG32	VG320	VG320
国内使用 Used in interior	广研润滑	WA460	
国外使用 Used in foreign Countries	IP	TELIUM VSF	MELLANA OIL 220
	SHELL	TIVELA OIL SC320	OMALA OIL 220
	AGIP	BLASIA S320	BLASIA 220
	MOBIL	GLYGOYLE 30	MOBILGEAR 220
	CASTROL	ALPHASYN PG 320	ALPHA MAX 220

参数符号对应表 Parameter & symbol contrast table

P = 功率 Power (Kw)	η = 效率 Efficiency	a = 轴向 Axial
M = 扭力 Torque (Nm)	γ = 前置角 Helix angle	s = 静态 Statical
n = 速度 Speed (rpm)	f.s. = 工作系数 Service factor	d = 动态 Dynamic
i = 减速比 Ratio	1 = 输入轴 Input shaft	max = 最大值
F = 负荷 Load (N)	2 = 输出轴 Output shaft	min = 最小值
m = 重量 Weight (kg)	r = 径向 Radial	



输入轴许用径向载荷 Applied mid-way along the input shaft

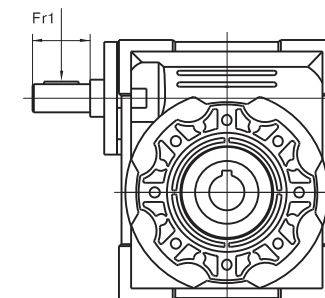

(N)

n1	NRV030	NRV040	NRV050	NRV063	NRV075	NRV090	NRV110	NRV130
1400	150	250	350	500	700	900	1200	1500
900	175	290	400	580	810	1040	1390	1740
500	210	350	490	700	980	1270	1700	2100

输出轴许用径向载荷 Applied mid-way along the output shaft

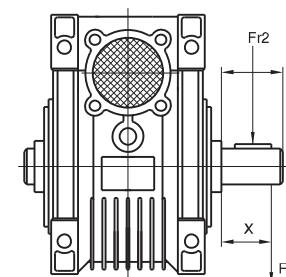

$$Fr_x = Fr \frac{a}{b+x}$$

(N)

n2	NRV025	NRV030	NRV040	NRV050	NRV063	NRV075	NRV090	NRV110	NRV130
400	390	530	1020	1400	1830	2160	2390	3020	3950
250	460	620	1200	1650	2150	2520	2800	3530	4610
150	550	740	1420	1960	2540	2990	3310	4180	5470
100	630	850	1620	2250	2910	3430	3800	4790	6260
60	740	1000	1920	2660	3450	4060	4500	5680	7420
40	850	1150	2200	3050	3950	4650	5150	6500	8500
25	990	1350	2570	3570	4620	5440	6020	7600	9940
10	1350	1830	3490	4840	6270	7380	8180	10320	13500

a	50	65	84	101	120	131	162	191	203
b	38	50	64	76	95	101	122	151	163

--表中的数值为作用于出力轴中点的许可加载力。
--当减速机为双出轴时，折算到轴端的径向合力不能超过表中规定的数值。
--当径向力和轴向力同时施加时，最大许可的轴向推力为径向力的1/5。
--Above table is the allowed loading force on the midpoint of output shaft.
--When the reducer is with double output shafts, the result tant radial power at the edge of shaft should not exceed the values specified as in above table.
---The max allowed axial thrust is 1/5 of radial force while the radial force and axial force effected together.

性能参数表 Performance

P1(Kw)	n2(1/min)	M2(Nm)	F.S.	i	减速机型号Type	Fr2(N)
0.06	280	1.8	6.2	5	NMRV025	439
	186.7	2.6	4.2	7.5		503
	140	3.4	3.5	10		553
	93.3	4.9	2.5	15		633
	70	6.1	2.0	20		697
	46.7	8.2	1.6	30		798
	35	10	1.3	40		878
	28	12	0.9	50		946
	23.3	14	0.7	60		1006
	280	1.8	10.1	5	NMRV030	597
	186.7	2.6	6.9	7.5		683
	140	3.4	5.4	10		752
	93.3	4.7	3.8	15		861
	70	6	3.0	20		948
	56	7	3.0	25		1021
	46.7	8	2.5	30		1085
	35	9.7	1.9	40		1194
	28	11	1.5	50		1286
	23.3	13	1.3	60		1367
	17.5	14	0.9	80		1504
0.09	280	2.7	4.1	5	NMRV025	439
	186.7	3.9	2.8	7.5		503
	140	5.1	2.4	10		533
	93.3	7.3	1.6	15		633
	70	9.2	1.3	20		697
	46.7	12	1.1	30		798
	35	15	0.9	40		878
	280	2.7	6.7	5	NMRV030	597
	186.7	3.9	4.6	7.5		683
	140	5	3.6	10		752
	93.3	7.1	2.5	15		861
	70	9	2.0	20		948
	56	10	2.0	25		1021
	46.7	12	1.7	30		1085
	35	14	1.2	40		1194
	28	17	1.0	50		1286
	23.3	19	0.9	60		1367
	28	19	2.0	50	NMRV040	2475
	23.3	21	1.7	60		2630
	17.5	26	1.3	80		2895
	14	29	1.0	100		3118
0.12	280	3.6	5.1	5	NMRV030	597
	186.7	5.2	3.4	7.5		683
	140	6.7	2.7	10		752
	93.3	9.5	1.9	15		861
	70	12	1.5	20		948
	56	14	1.5	25		1021
	46.7	16	1.3	30		1085
	35	19	0.9	40		1194
	28	23	0.8	50		1286
	46.7	17.2	2.6	30	NMRV040	2087
	35	21	1.9	40		2298
	28	25	1.5	50		2475

性能参数表 Performance

P1(Kw)	n2(1/min)	M2(Nm)	F.S.	i	减速机型号Type	Fr2(N)
0.12	23	28	1.3	60	NMRV040	2630
	17.5	34	1.0	80		2895
	14	38	0.8	100		3118
	23.3	29	2.3	60	NMRV050	3610
	17.5	35	1.9	80		3973
	14	40	1.4	100		4280
0.18	280	5.3	3.4	5	NMRV030	597
	186.7	7.8	2.3	7.5		683
	140	10	1.8	10		752
	93.3	14	1.3	15		861
	70	18	1.0	20		948
	56	21	1.0	25		1021
	46.7	24	0.8	30	NMRV040	1085
	70	19.2	2.0	20		1824
	56	23	1.7	25		1964
	46.7	26	1.7	30		2087
	35	32	1.3	40		2298
	28	38	1.0	50		2475
	23.3	43	0.8	60	NMRV050	2630
	35	32.9	2.3	40		3153
	28	39	1.9	50		3397
	23.3	43	1.6	60		3610
	17.5	52	1.2	80		3973
	14	60	0.9	100		4280
0.22	280	6.5	2.8	5	NMRV030	597
	186.7	10	1.9	7.5		683
	140	12	1.5	10		752
	93.3	17	1.0	15		861
	70	22	0.8	20	NMRV040	948
	93.3	18.5	2.2	15		1657
	70	23	1.7	20		1824
	56	28	1.4	25		1964
	46.7	32	1.4	30		2087
	35	39	1.1	40		2298
	28	47	0.8	50		2475
	28	47.3	1.5	50	NMRV050	3397
	23.3	53	1.3	60		3610
	17.5	64	1.0	80		3973
0.25	280	7.6	4.5	5	NMRV040	1149
	186.7	11	3.6	7.5		1315
	140	14	2.8	10		1447
	93.3	21	1.9	15		1657
	70	27	1.5	20		1824
	56	32	1.2	25		1964
	46.7	36	1.3	30		2087
	35	44	0.9	40		2298
	70	26.9	2.7	20	NMRV050	2503
	56	32	2.2	25		2696
	46.7	37	2.3	30		2865
	35	46	1.7	40		3153
	28	54	1.4	50		3397
	23.3	60	1.1	60		3610
	17.5	72	0.9	80		3973

性能参数表 Performance

P1(Kw)	n2(1/min)	M2(Nm)	F.S.	i	减速机型号Type	Fr2(N)
0.25	28	56.3	2.4	50	NMRV063	4440
	23.3	63	2.0	60		4719
	17.5	78	1.6	80		5193
	14	87	1.4	100	NMRV075	5595
	17.5	81.9	2.3	80		6130
0.37	14	94	1.9	100	NMRV040	6603
	280	11.2	3.0	5		1149
	186.7	16	2.4	7.5		1315
	140	21	1.9	10		1447
	93.3	31	1.3	15		1657
	70	39	1.0	20		1824
	56	47	0.8	25		1964
	46.7	53	0.8	30	NMRV050	2087
	140	21.7	3.3	10		1987
	93.3	31	2.4	15		2274
	70	40	1.8	20		2503
	56	48	1.5	25		2696
	46.7	55	1.5	30		2865
	35	68	1.1	40		3153
	28	80	0.9	50	NMRV063	3397
	23.3	89	0.8	60		3610
	35	70.7	2.1	40		4122
	28	83	1.6	50		4440
	23.3	94	1.4	60		4719
	17.5	115	1.1	80		5193
	14	129	0.9	100		5595
	23.3	98.4	2.0	60	NMRV075	5569
	17.5	121	1.6	80		6130
	14	139	1.3	100		6603
0.55	280	16.7	2.0	5	NMRV040	1149
	186.7	24	1.6	7.5		1315
	140	32	1.3	10		1447
	93.3	46	0.9	15		1657
	280	16.7	3.7	5	NMRV050	1577
	186.7	25	2.9	7.5		1805
	140	32	2.2	10		1987
	93.3	46	1.6	15		2274
	70	59	1.2	20		2503
	56	71	1.0	25		2696
	46.7	81	1.0	30		2865
	70	60.8	2.2	20	NMRV063	3272
	56	73	1.8	25		3524
	46.7	83	1.9	30		3745
	35	105	1.4	40		4122
	28	124	1.1	50		4440
	23.3	140	0.9	60		4719
	35	108.1	2.0	40	NMRV075	4865
	28	129	1.6	50		5241
	23.3	146	1.4	60		5569
	17.5	180	1.1	80		6130
	14	206	0.9	100		6603
	17.5	189.1	1.5	80	NMRV090	6783
	14	221	1.2	100		7306

性能参数表 Performance

P1(Kw)	n2(1/min)	M2(Nm)	F.S.	i	减速机型号Type	Fr2(N)
0.55	17.5	201.1	2.6	80	NMRV110	8571
	14	236	2.0	100		9232
	280	22.8	2.7	5	NMRV050	1577
	186.7	34	2.1	7.5		1805
	140	44	1.6	10		1987
0.75	93.3	63	1.2	15		2274
	70	81	0.9	20		2503
	93.3	63.7	2.2	15	NMRV063	2973
	70	83	1.6	20		3272
	56	100	1.3	25		3524
	46.7	114	1.4	30		3745
	35	143	1.0	40	NMRV075	4122
	56	102.3	2.0	25		4160
	46.7	117	2.0	30		4421
	35	147	1.5	40		4865
	28	177	1.2	50	NMRV090	5241
	23.3	200	1.0	60		5569
	28	184.2	1.8	50		5799
	23.3	212	1.5	60	NMRV110	6163
	17.5	258	1.1	80		6783
	14	302	0.9	100		7306
	17.5	274.2	1.9	80	NMRV110	8571
	14	322	1.5	100		9232
	186.7	49.5	2.6	7.5	NMRV063	2359
	140	65	2.0	10		2597
	93.3	93	1.5	15		2973
	70	122	1.1	20		3272
	56	146	0.9	25		3524
	46.7	167	1.0	30		3745
1.1	93.3	95.7	2.1	15	NMRV075	3509
	70	123	1.7	20		3862
	56	150	1.3	25		4160
	46.7	171	1.3	30		4421
	35	216	1.0	40	NMRV090	4865
	35	225.1	1.6	40		5383
	28	270	1.3	50		5799
	23.3	311	1.0	60	NMRV110	6163
	28	281.4	2.3	50		7328
	23.3	324	1.9	60		7787
	17.5	402	1.3	80		8571
	14	473	1.0	100	NMRV130	9232
	17.5	408.2	2.1	80		11210
	14	480	1.5	100		12076
1.5	186.7	67.5	1.9	7.5	NMRV063	2359
	140	89	1.5	10		2597
	93.3	127	1.1	15		2973
	70	166	0.8	20		3272
	140	90	2.2	10	NMRV075	3065
	93.3	130	1.5	15		3509
	70	168	1.3	20		3862
	56	205	1.0	25		4160
	46.7	233	1.0	30		4421

性能参数表 Performance

P1(Kw)	n2(1/min)	M2(Nm)	F.S.	i	减速机型号Type	Fr2(N)
1.5	70	171.9	2.1	20	NMRV090	4273
	56	210	1.6	25		4603
	46.7	239	1.6	30		4890
	35	307	1.2	40		5383
	28	368	0.9	50		5799
	23.3	424	0.8	60		6163
	35	319.2	2.2	40	NMRV110	6803
	28	384	1.7	50		7328
	23.3	442	1.4	60		7787
	17.5	548	0.9	80		8571
	17.5	556.6	1.5	80	NMRV130	11210
	14	655	1.1	100		12076
2.2	186.7	100.2	1.8	7.5	NMRV075	2785
	140	132	1.5	10		3065
	93.3	191	1.0	15		3509
	186.7	101.3	2.9	7.5	NMRV090	3081
	140	134	2.3	10		3391
	93.3	194	1.9	15		3882
	70	252	1.4	20		4273
	56	308	1.1	25		4603
	46.7	315	1.2	30		4891
	70	255.1	2.5	20	NMRV110	5399
	56	315	2.2	25		5816
	46.7	356	2.0	30		6181
	35	468	1.5	40		6803
	28	563	1.2	50		7328
	23.3	648	1.0	60		7787
	35	468.2	2.2	40	NMRV130	8897
	28	563	1.7	50		9584
	23.3	684	1.4	60		10185
	17.5	816	1.0	80		11210
	186.7	136.6	1.4	7.5	NMRV075	2785
	140	180	1.1	10		3065
	93.3	261	0.8	15		3509
3	186.7	138.1	2.1	7.5	NMRV090	3081
	140	182	1.7	10		3391
	93.3	264	1.4	15		3882
	70	344	1.0	20		4273
	56	420	0.8	25		4603
	46.7	479	0.9	30		4891
	93.3	264	2.5	15	NMRV110	4905
	70	348	1.9	20		5399
	56	430	1.6	25		5816
	46.7	485	1.5	30		6181
	35	638	1.1	40		6803
	28	767	0.9	50		7328
	56	429.8	2.2	25	NMRV130	7607
	46.7	491	2.1	30		8084
	35	638	1.6	40		8897
	28	767	1.3	50		9584
	23.3	884	1.0	60		10185
	17.5	1113	0.8	80		11210

性能参数表 Performance

P1(Kw)	n2(1/min)	M2(Nm)	F.S.	i	减速机型号Type	Fr2(N)
4	186.7	184.2	1.6	7.5	NMRV090	3081
	140	243	1.3	10		3391
	93.3	352	1.0	15		3882
	70	458	0.8	20		4273
	140	242.8	2.5	10	NMRV110	4285
	93.3	352	1.9	15		4905
	70	464	1.4	20		5399
	56	573	1.2	25		5816
	46.7	647	1.1	30	NMRV130	6181
	56	573	1.6	25		7607
	46.7	655	1.6	30		8084
	35	851	1.2	40		8897
4.8	28	1023	1.0	50	NMRV130	9584
	23.3	1179	0.8	60		10185
	186.7	211	1.3	7.5	NMRV090	3081
	140	291	1.1	10		3391
	93.3	422	0.9	15		3882
	186.7	221	2.5	7.5	NMRV110	3893
	140	291	2.1	10		4285
	93.3	422	1.6	15		4905
	70	557	1.2	20		5399
	56	688	1.0	25	NMRV130	5816
	56	687.6	1.4	25		7607
	46.7	786	1.3	30		8084
	35	1022	1.0	40		8897
	28	1228	0.8	50		9584
	186.7	253.2	2.2	7.5	NMRV110	3893
	140	334	1.8	10		4285
	93.3	484	1.4	15		4905
	70	638	1.0	20		5399
5.5	140	333.9	2.5	10	NMRV130	5605
	93.3	490	1.9	15		6416
	70	645	1.4	20		7062
	56	788	1.2	25		7607
	46.7	900	1.2	30	NMRV110	8084
	35	1171	0.9	40		8897
	186.7	345.3	1.6	7.5	NMRV110	3893
	140	455	1.3	10		4285
	93.3	660	1.0	15		4905
	186.7	349.2	2.1	7.5	NMRV130	5092
	140	455	1.8	10		5605
	93.3	668	1.4	15		6416
	70	880	1.0	20		7062
	56	1074	0.9	25		7607
	46.7	1228	0.8	30		8084
7.5	35	1596	0.7	40		8897
	186.7	423.6	1.3	7.5	NMRV110	3893
	186.7	428.3	1.8	7.5	NMRV130	5092
	140	559	1.5	10		5605
	93.3	819	1.1	15		6416
	70	1079	0.8	20		7062
	56	1318	0.7	25		7607



NRV性能参数表 Performance

(n1=1400)

M2(Nm)	i	P1(Kw)	n2(1/min)	减速机型号Type	Fr2(N)	Fr1(N)
18	5	0.6	280	NRV030	597	150
18	7.5	0.4	186.7		683	150
18	10	0.3	140		752	169
18	15	0.2	93.3		861	169
18	20	0.2	70		984	190
21	25	0.2	56		1021	210
20	30	0.2	46.7		1085	210
18	40	0.1	35		1194	210
17	50	0.1	28		1286	210
16	60	0.1	23.3		1367	210
13	80	0.1	17.5		1504	210
34	5	1.1	280	NRV040	1149	250
40	7.5	0.9	186.7		1315	294
40	10	0.7	140		1447	331
40	15	0.5	93.3		1657	331
39	20	0.4	70		1824	350
38	25	0.3	56		1964	350
45	30	0.3	46.7		2087	350
41	40	0.2	35		2298	350
39	50	0.2	28		2475	350
36	60	0.2	23.3		2630	350
33	80	0.1	17.5		2895	350
29	100	0.1	14		3118	350
62	5	2.0	280	NRV050	1577	350
71	7.5	1.6	186.7		1805	401
72	10	1.2	140		1987	490
74	15	0.9	93.3		2274	490
73	20	0.7	70		2503	490
70	25	0.5	56		2696	490
84	30	0.6	46.7		2865	490
76	40	0.4	35		3153	490
73	50	0.3	28		3397	490
68	60	0.3	23.3		3610	490
65	80	0.2	17.5		3973	490
55	100	0.2	14		4280	490
128	7.5	2.8	186.7	NRV063	2359	500
130	10	2.2	140		2597	571
140	15	1.6	93.3		2973	615
135	20	1.2	70		3272	667
130	25	1.0	56		3524	700
160	30	1.1	46.7		3745	700
145	40	0.8	35		4122	700
135	50	0.6	28		4440	700
130	60	0.5	23.3		4719	700
122	80	0.4	17.5		5193	700
118	100	0.3	14		5595	700



NRV性能参数表 Performance

(n1=1400)

M2(Nm)	i	P1(Kw)	n2(1/min)	减速机型号Type	Fr2(N)	Fr1(N)
185	7.5	4.1	186.7	NRV075	2785	700
195	10	3.2	140		3065	830
200	15	2.3	93.3		3509	851
210	20	1.9	70		3862	980
200	25	1.5	56		4160	980
230	30	1.5	46.7		4421	980
220	40	1.1	35		4865	980
210	50	0.9	28		5241	980
200	60	0.8	23.3		5569	980
190	80	0.6	17.5		6130	980
180	100	0.5	14		6603	980
290	7.5	6.3	186.7	NRV090	3081	900
310	10	5.1	140		3391	1082
360	15	4.1	93.3		3882	1257
355	20	3.1	70		4273	1270
340	25	2.4	56		4603	1270
410	30	2.6	46.7		4891	1270
360	40	1.8	35		5383	1270
340	50	1.4	28		5799	1270
320	60	1.1	23.3		6163	1270
285	80	0.8	17.5		6783	1270
370	100	0.7	14		7306	1270
552	7.5	12	186.7	NRV110	3893	1200
598	10	9.8	140		4285	1463
656	15	7.5	93.3		4905	1604
644	20	5.6	70		5399	1700
679	25	4.7	56		5816	1700
725	30	4.5	46.7		6181	1700
702	40	3.3	35		6803	1700
660	50	2.6	28		7328	1700
616	60	2.1	23.3		7787	1700
515	80	1.4	17.5		8571	1700
483	100	1.1	14		9232	1700
750	7.5	16.1	186.7	NRV130	5092	1500
820	10	13.5	140		5605	1845
920	15	10.3	93.3		6416	2070
910	20	7.8	70		7062	2100
930	25	6.5	56		7607	2100
1040	30	6.4	46.7		8084	2100
1050	40	4.9	35		8897	2100
980	50	3.8	28		9584	2100
900	60	3.1	23.3		10185	2100
840	80	2.3	17.5		11210	2100
740	100	1.7	14		12076	2100



减速机外型尺寸 Dimensions NMRV025

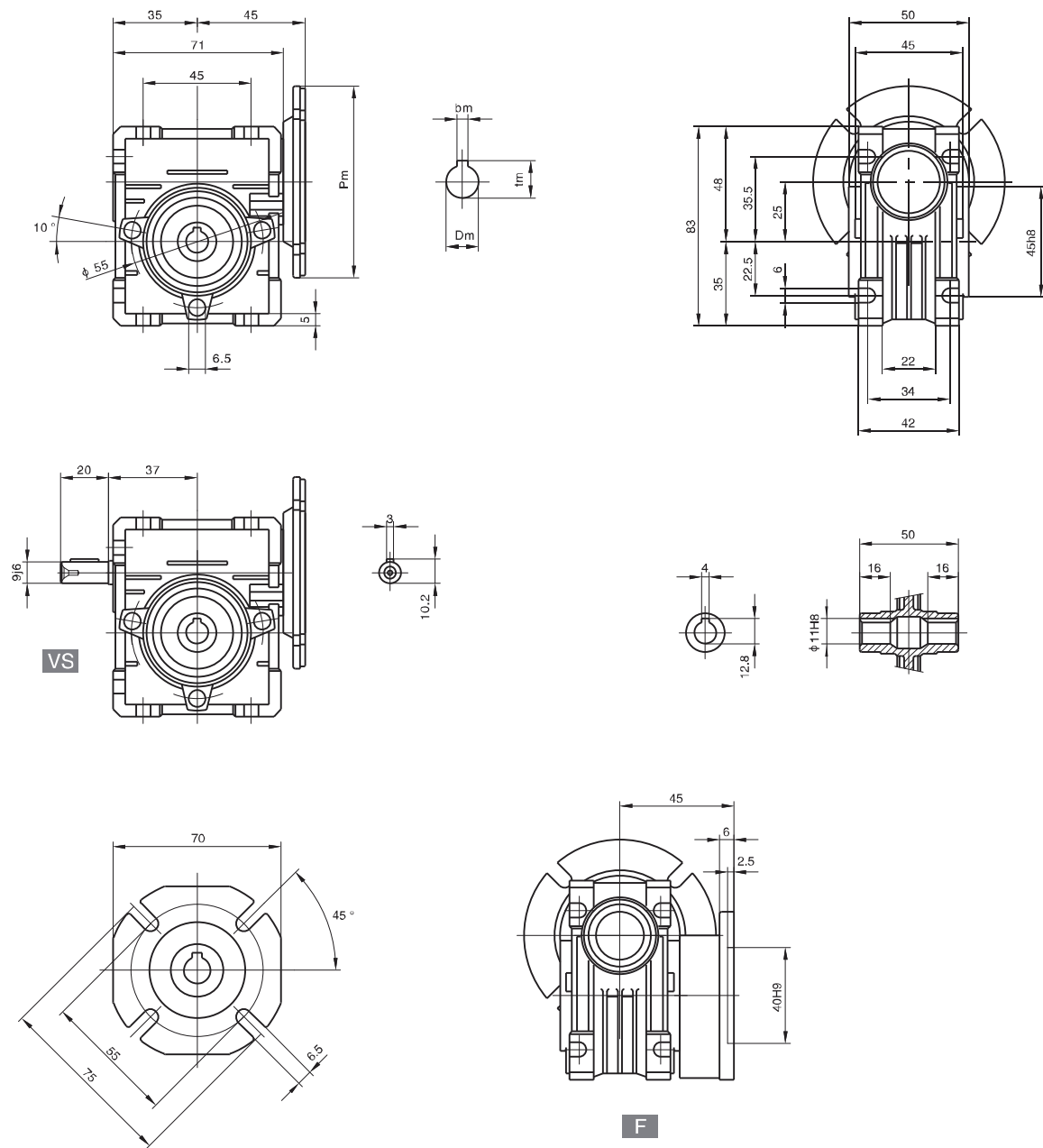

*不带马达重量为: 0.7kg
*Weight without motor: 0.7kg

输入法兰可配I(R)K系列马达 I (R) K series motors
法兰尺寸 Flange size: 70×70、80×80、90×90

马达型号 Motor model	功率 Power (W)			
3I(R)K	10	15	20	30
4I(R)K	25	30	40	
5I(R)K	40	60	90	120



减速机外型尺寸 Dimensions NMRV030

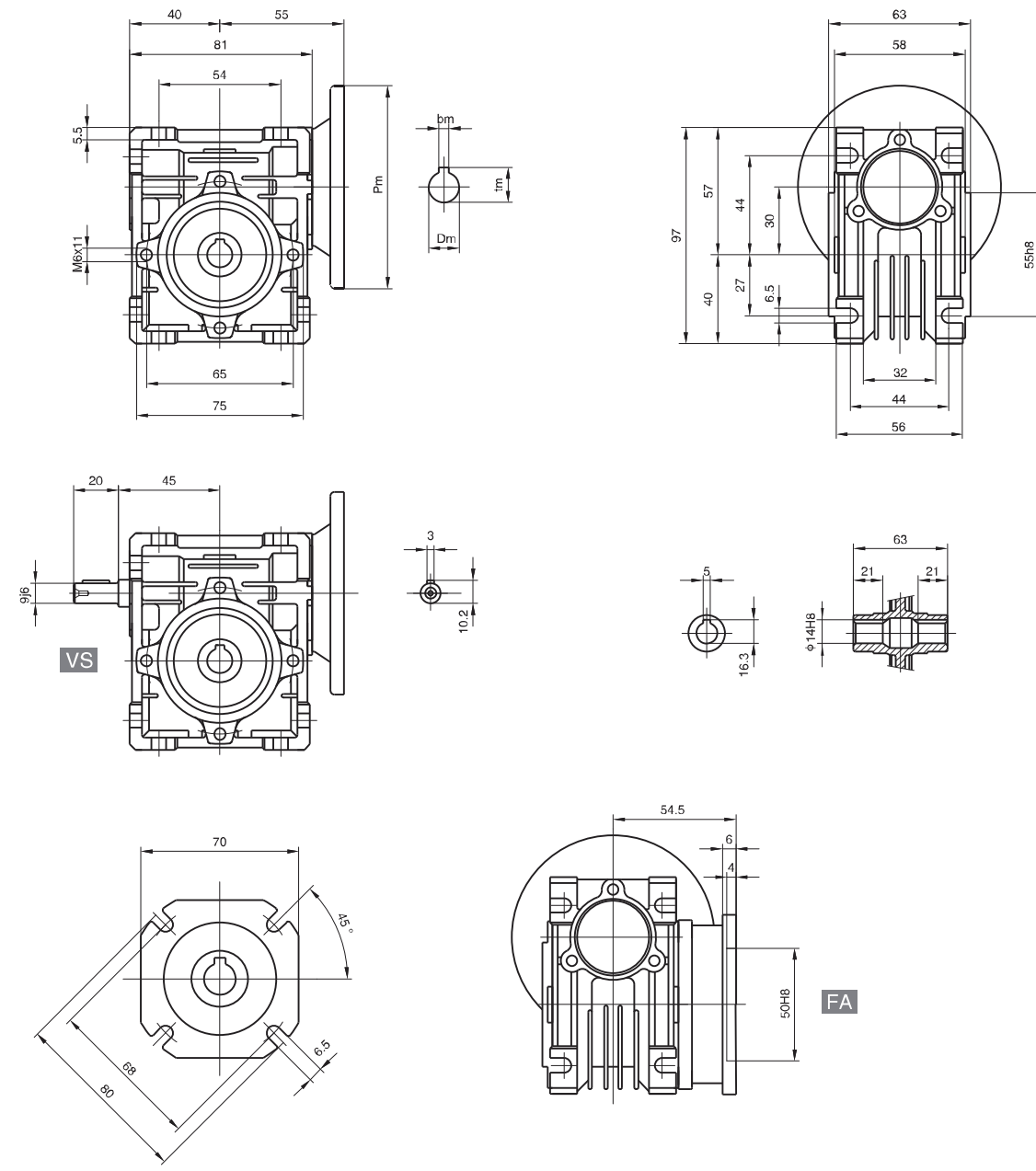

*不带马达重量为: 1.2kg
*Weight without motor: 1.2kg

输入法兰可配I(R)K系列马达 I (R) K series motors
法兰尺寸 Flange size: 80×80、90×90、104×104

马达型号 Motor model	功率 Power (W)			
4I(R)K	25	30	40	
5I(R)K	40	60	90	120
6I(R)K	70	120	140	180 200



减速机外型尺寸 Dimensions NMRV040

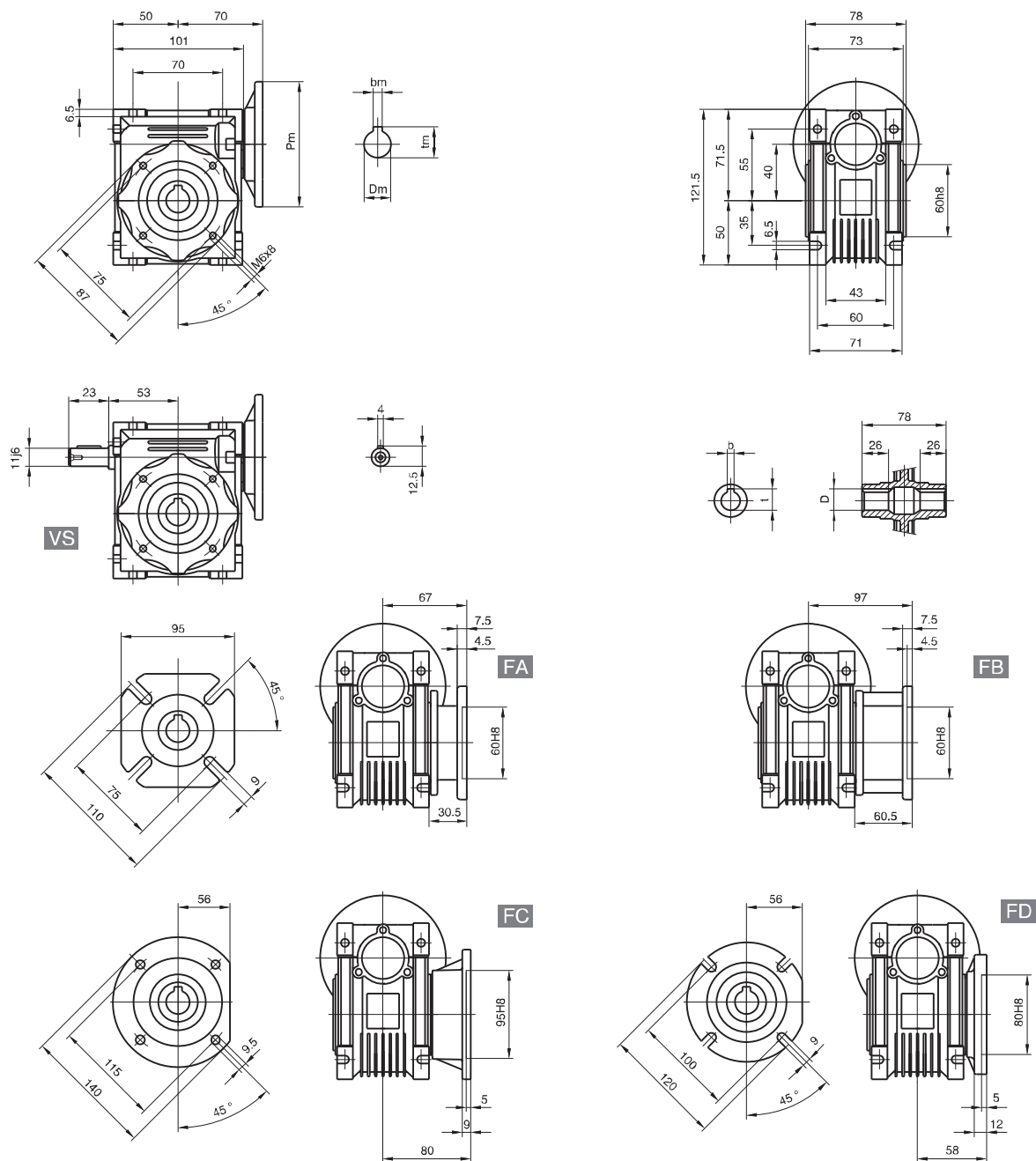

输出/Output		
D H8	b	t
18 (19)	6 (6)	20.8 (21.8)

(..)根据用户要求定制 Only on request

*不带马达重量为: 2.3kg Weight without motor: 2.3kg

输入法兰可配I(R)K系列马达 I (R) K series motors
法兰尺寸 Flange size: 90×90、104×104

马达型号 Motor model	功率 Power (W)			
5I(R)K	40	60	90	120
6I(R)K	70	120	140	180 200



减速机外型尺寸 Dimensions NMRV050

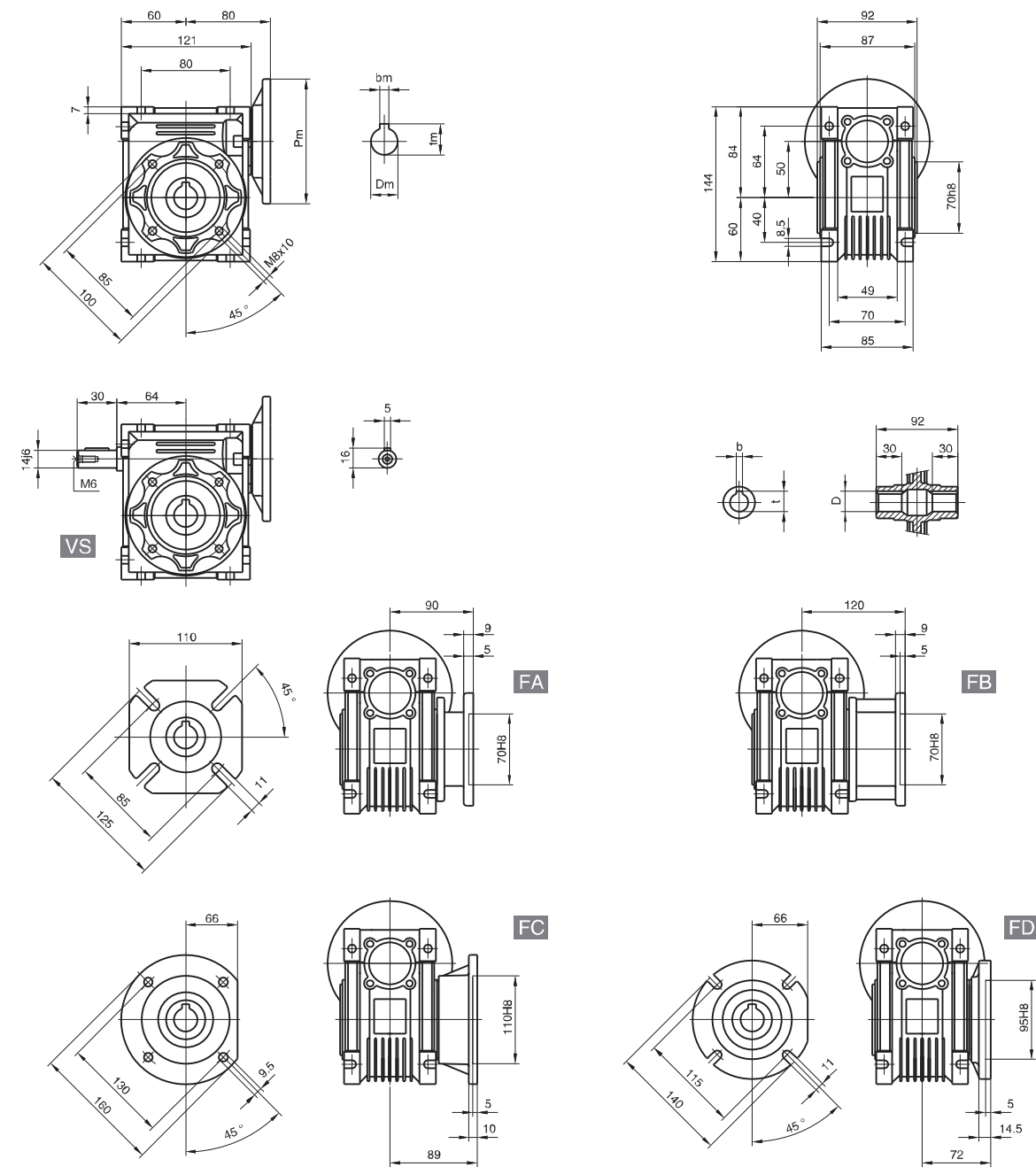

输出/Output		
D H8	b	t
25 (24)	8 (8)	28.3 (27.3)

(..)根据用户要求定制 Only on request

*不带马达重量为: 3.5kg Weight without motor: 3.5kg

输入法兰可配I(R)K系列马达 I (R) K series motors
法兰尺寸 Flange size: 104×104

马达型号 Motor model	功率 Power (W)			
6I(R)K	70	120	140	180 200

减速机外型尺寸 Dimensions NMRV063

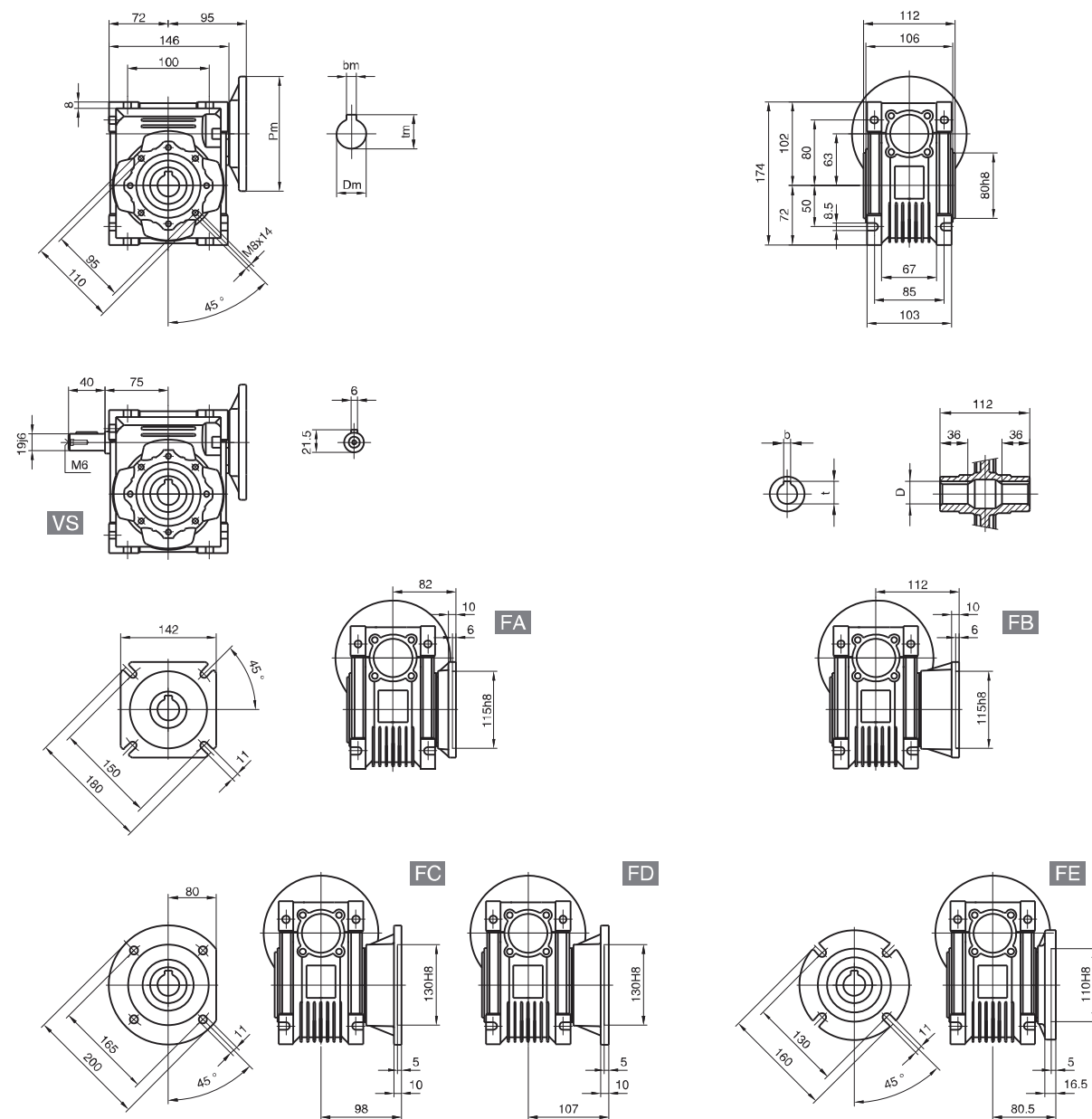

輸出/Output		
D H8	b	t
25	8	28.3
(28)	(8)	(31.3)

(..)根据用户要求定制 Only on request
*不带马达重量为: 6.2kg Weight without motor: 6.2kg

减速机外型尺寸 Dimensions NMRV075

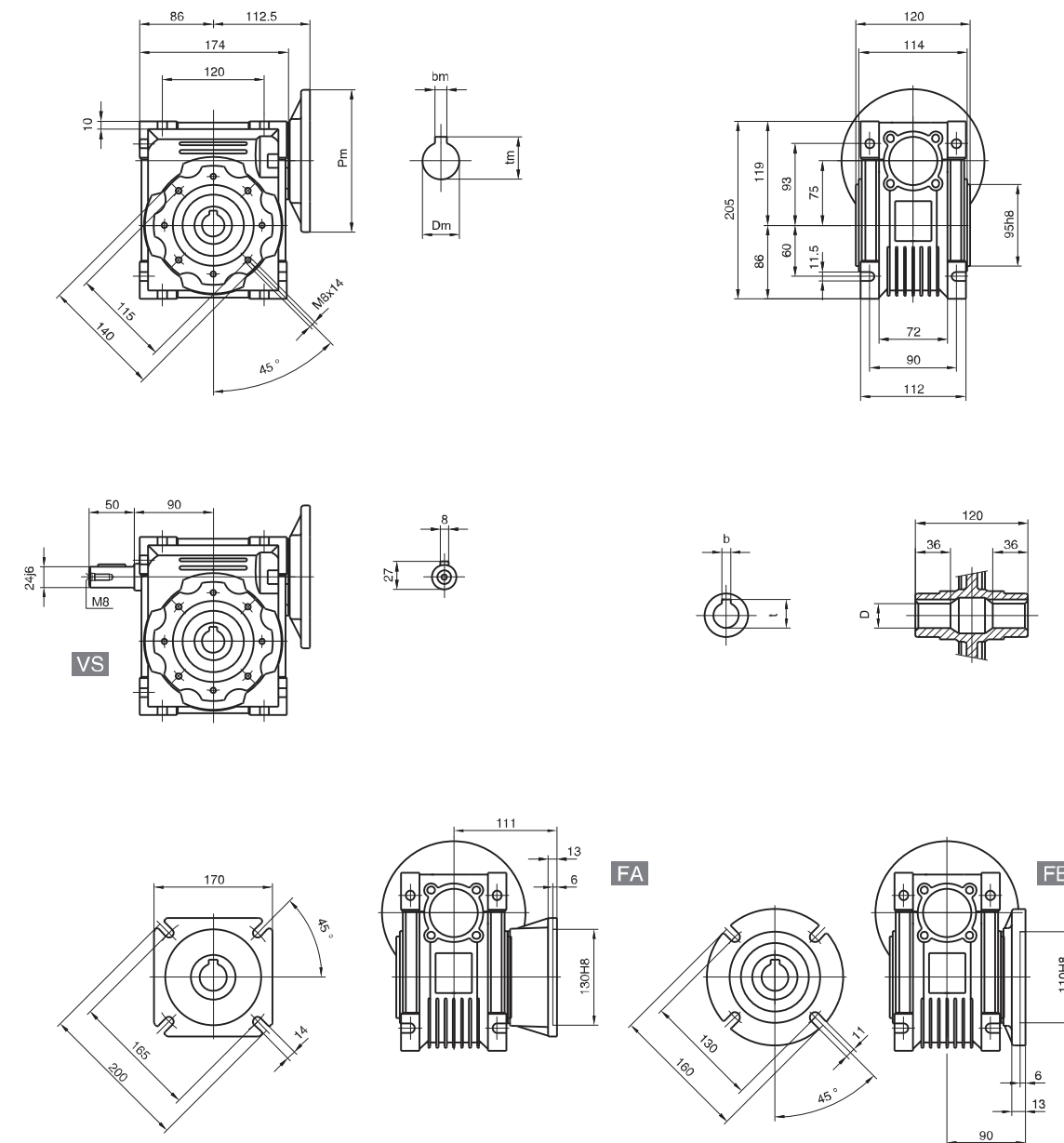

输出/Output		
D H8	b	t
28	8	31.3
(35)	(10)	(38.3)

(..)根据用户要求定制 Only on request
*不带马达重量为: 9kg Weight without motor: 9kg



减速机外型尺寸 Dimensions NMRV090

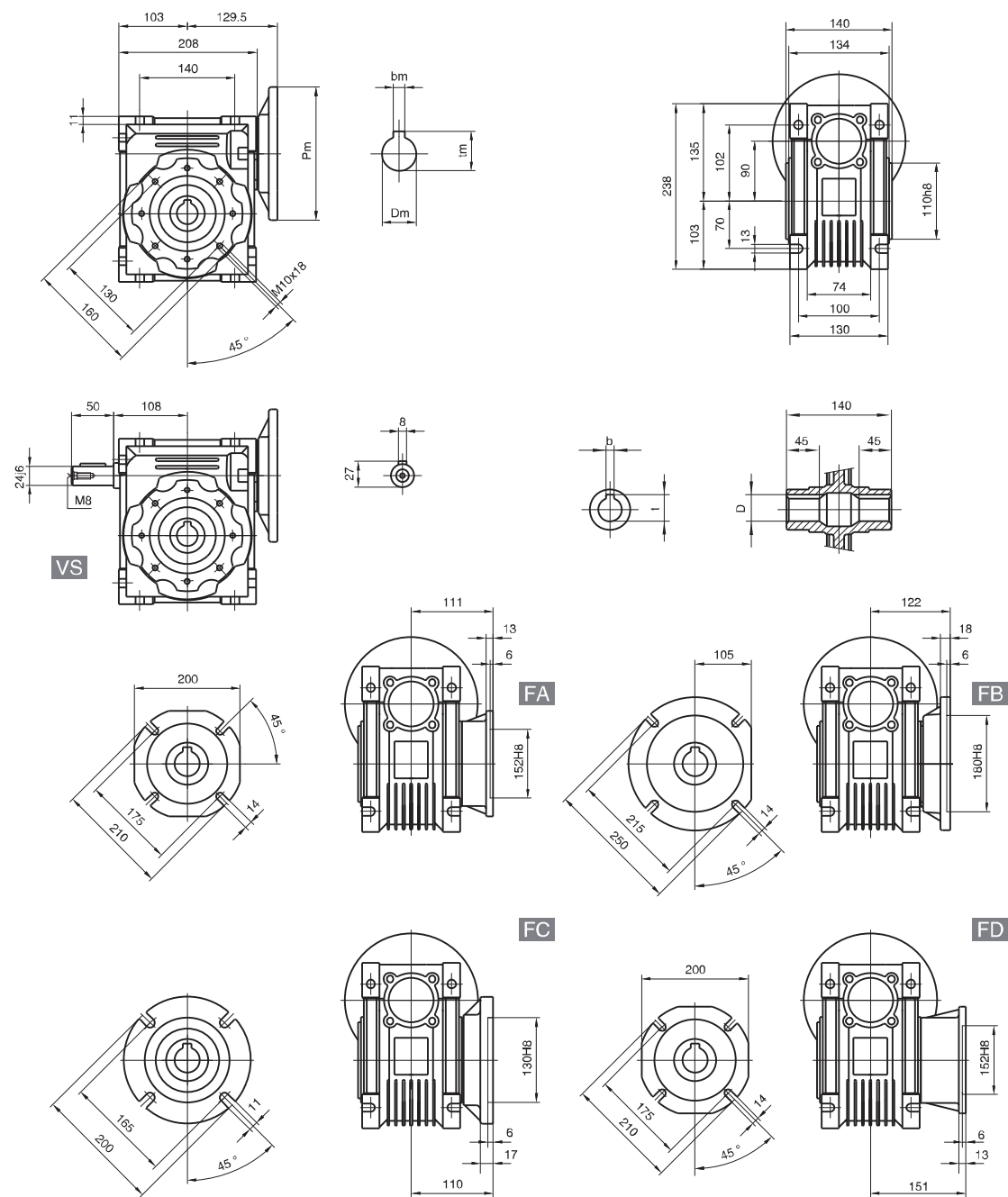

输出/Output		
D H8	b	t
35 (38)	10 (10)	38.3 (41.3)

(..)根据用户要求定制 Only on request
*不带马达重量为: 13kg Weight without motor: 13kg



减速机外型尺寸 Dimensions NMRV110

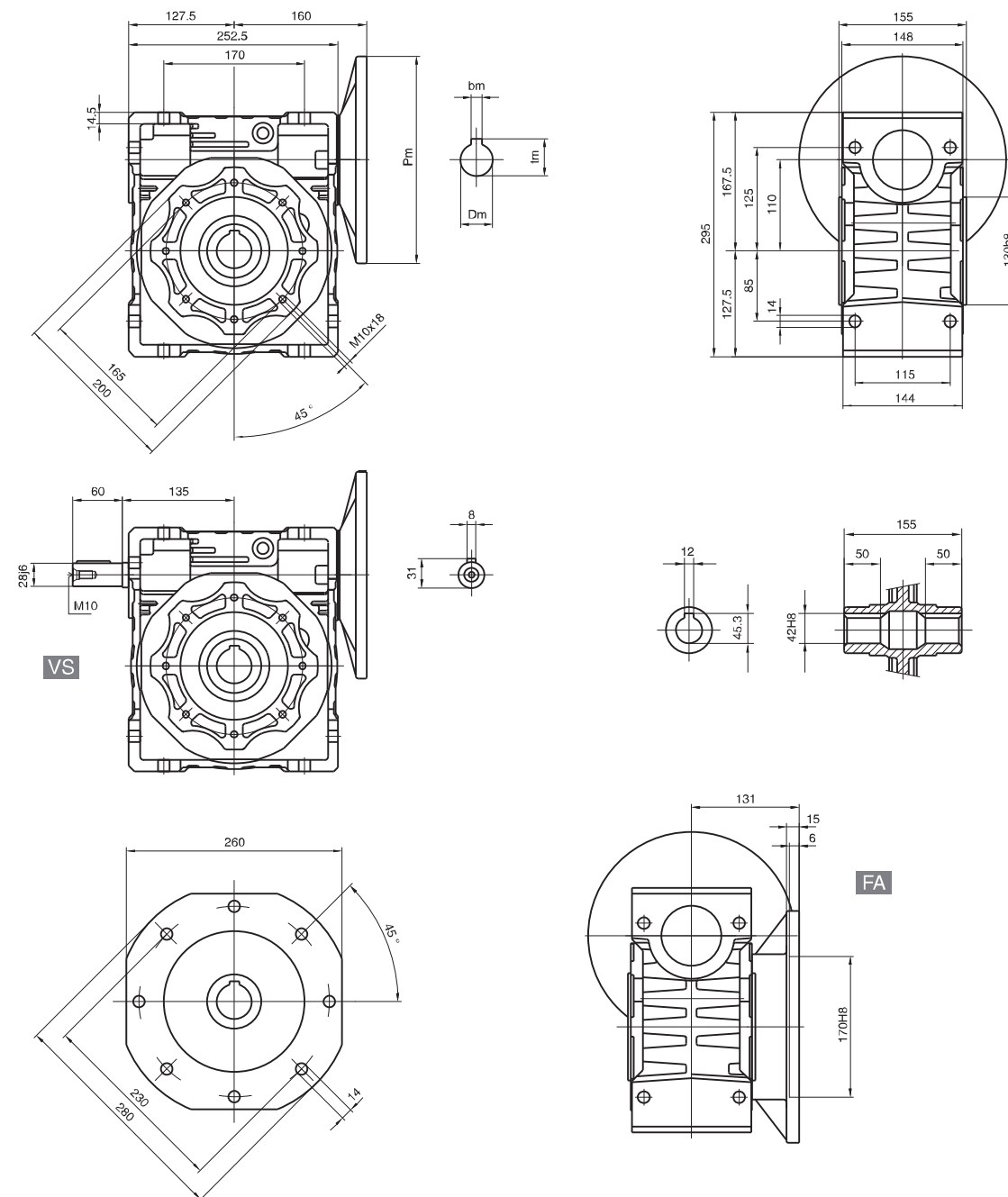

(..)根据用户要求定制 Only on request
*不带马达重量为: 35kg Weight without motor: 35kg

减速机外型尺寸 Dimensions NMRV130

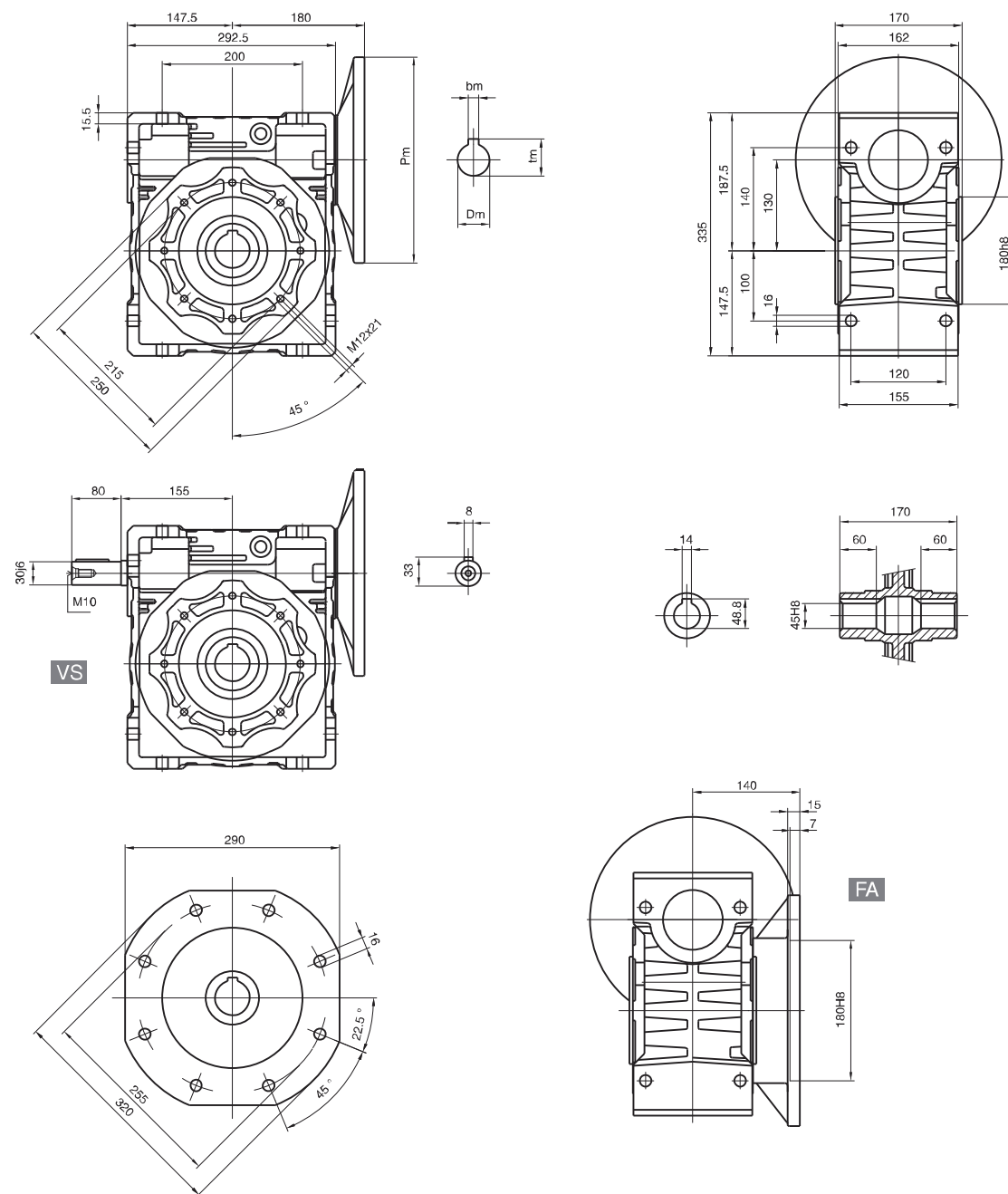

(..)根据用户要求定制 Only on request
*不带马达重量为: 48kg Weight without motor: 48kg

单向/双向输出轴尺寸 Size of single/double output shaft

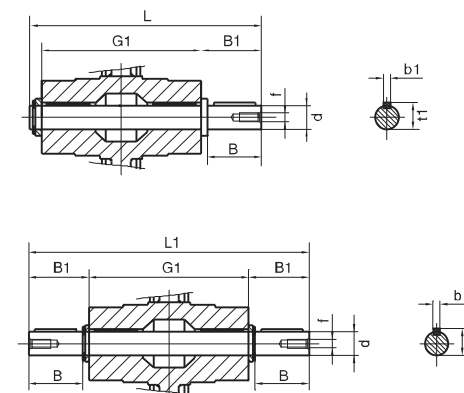

	d	B	B1	G1	L	L1	f	b1	t1
025	11g6 (9)	23 (25)	25.5 (30)	50	81 (85.5)	101	—	4 (3)	12.5 (10.2)
030	14 g6	30	32.5	63	102	128	M6	5	16
040	18 h6	40	43	78	128	164	M6	6	20.5
050	25 h6	50	53.5	92	153	199	M10	8	28
063	25 h6	50	53.5	112	173	219	M10	8	28
075	28 h6	60	63.5	120	192	247	M10	8	31
090	35 h6	80	84.5	140	234	309	M12	10	38
110	42 h6	80	84.5	155	249	324	M16	12	45
130	45 h6	80	85	170	265	340	M16	14	48.5

注：输出轴可按用户要求定制 Only on request

双向输入轴尺寸 Size of double input shaft

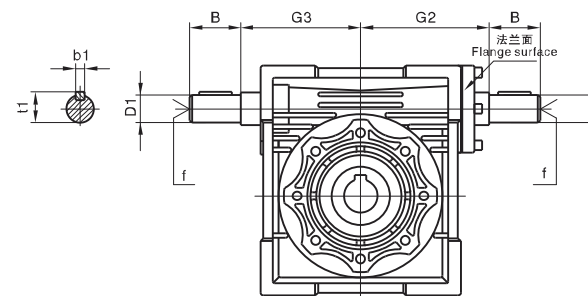

	G2, G3	D1(j6)	B	f	b1	t1
030	45	9	20	—	3	10.2
040	53	11	23	—	4	12.5
050	64	14	30	M6	5	16
063	75	19	40	M6	6	21.5
075	90	24	50	M8	8	27
090	108	24	50	M8	8	27
110	135	28	60	M10	8	31
130	155	30	80	M10	8	33

扭力臂尺寸 Sizes of torque arm

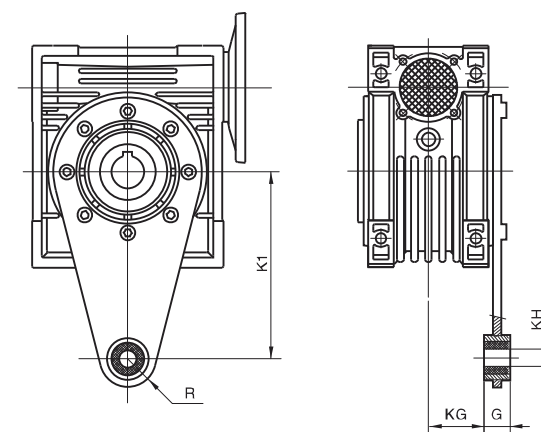

	K1	G	KG	KH	R
025	70	14	17.5	8	15
030	85	14	24	8	15
040	100	14	31.5	10	18
050	100	14	38.5	10	18
063	150	14	49	10	18
075	200	25	47.5	20	30
090	200	25	57.5	20	30
110	250	30	62	25	35
130	250	30	69	25	35



NMRV-NMRV

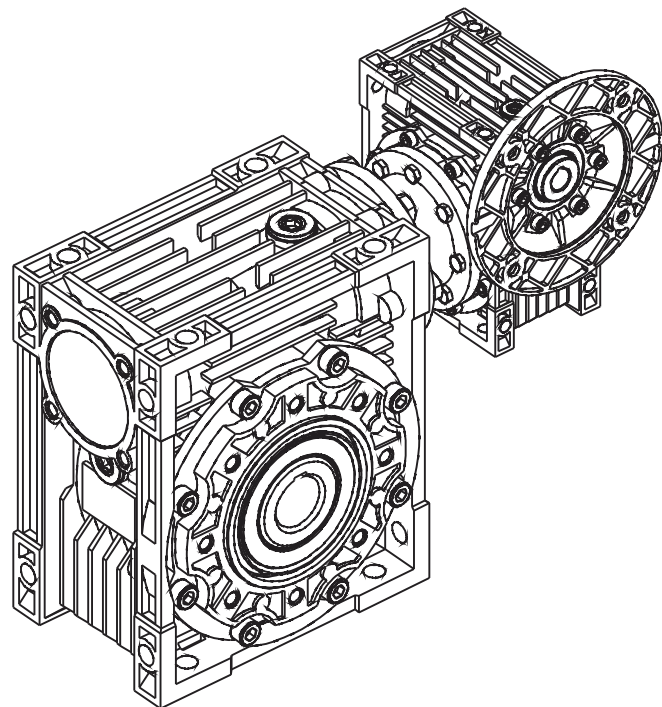

NMRV-NMRV型号标记 NMRV-NMRV Model & marker

NMRV-040/090-500-VS-F1(FA)-AS-80B5-0.75kW-AS1			
NMRV+NMRV	双蜗轮减速机 Combined worm geared motor	PAM	马达联接 Fitted for motor coupling
NRV+NMRV	配输入轴双蜗轮减速机 Combined worm reduction unit	0.75kW	马达功率 Electric motor power
040/090	蜗轮减速机中心距 Center distance	F1(FA)	输出法兰位置及型号 Output flange
500	减速比 Reduction ratio	AB	双向输出轴 Double output shaft
VS	双向输入轴 Double input shaft	80B5	电机机座号和安装结构形式 Motor mounting facility
AS	单向输出轴 Single output shaft	AS1	安装方位 Mounting position



NMRV-NMRV安装方位 Mounting positions

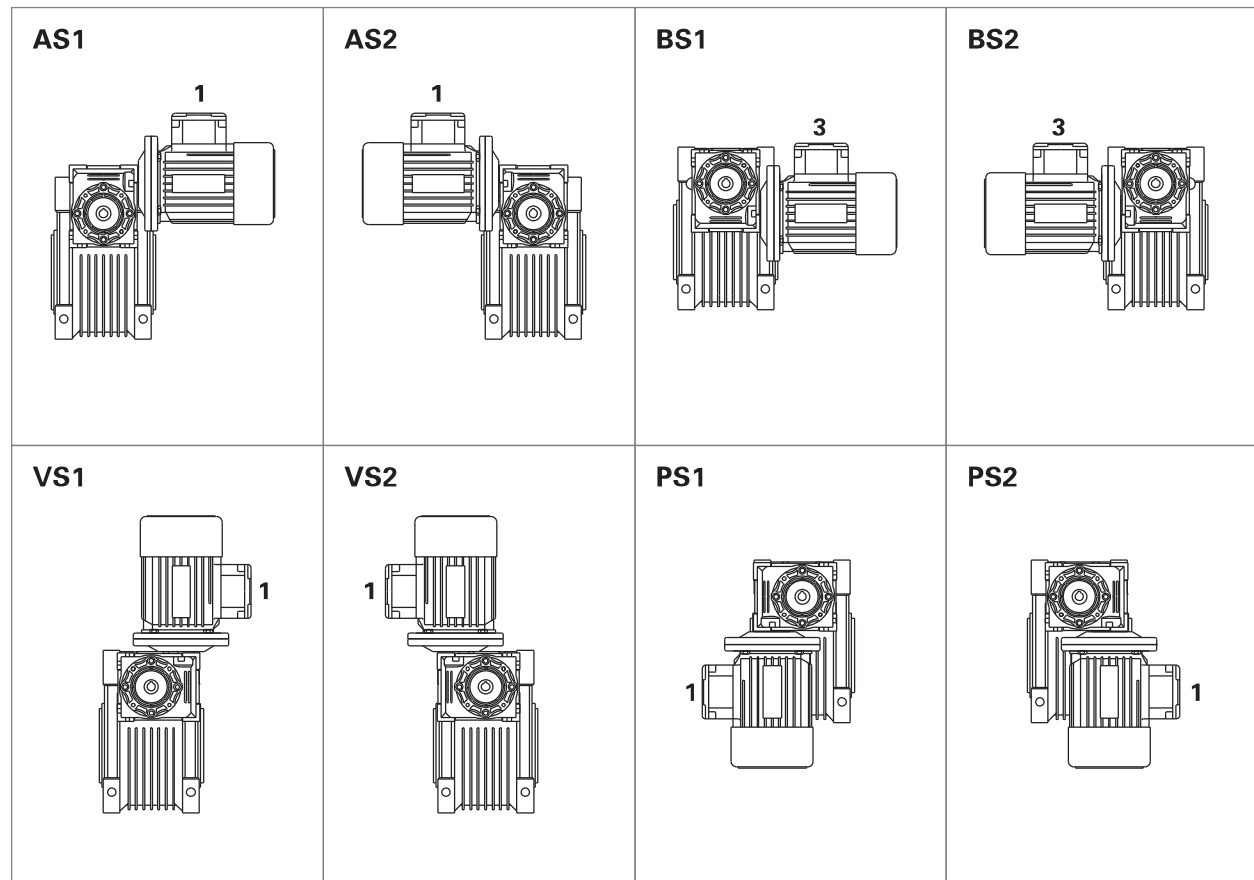

接线盒安装方式 Position of terminal box

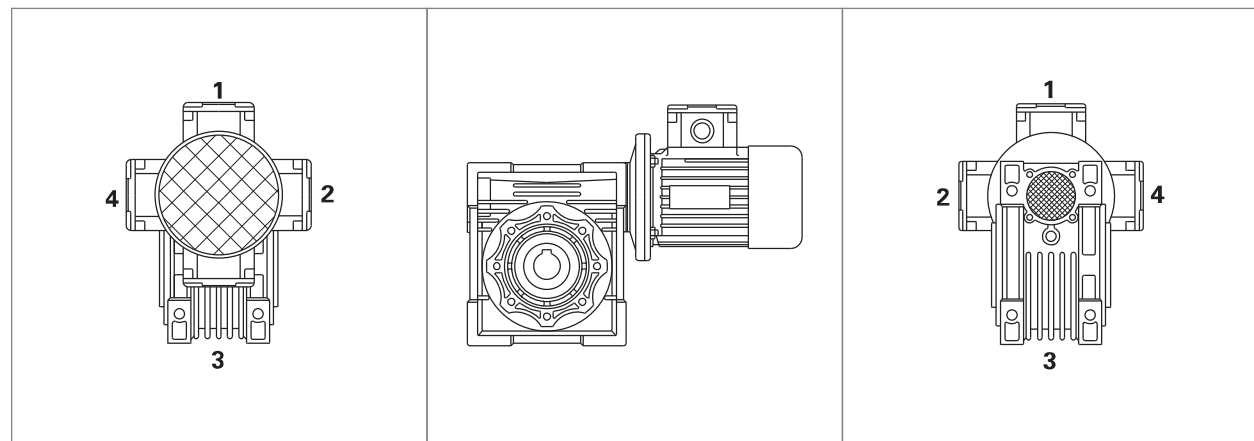



NMRV–NMRV参数表 Parameter table

型号 Type	i	n2	P1 kW1	M2 (Nm)	i1	i2
NRV 030/040	300	4.7	0.08	73	10	30
	400	3.5	0.06	65	10	40
	500	2.8	0.04	61	20	25
	600	2.3	0.04	73	20	30
	750	1.9	0.04	73	25	30
	900	0.6	0.03	73	30	30
	1200	1.2	0.02	65	30	40
	1500	0.9	0.02	73	50	30
	1800	0.8	0.02	73	60	30
	2400	0.58	0.01	65	60	40
	3200	0.4	0.01	65	80	40
	4000	0.4	0.01	33	50	80
NRV 030/050	5000	0.28	0.01	29	50	100
	300	4.7	0.15	145	10	30
	400	3.5	0.1	124	10	40
	500	2.8	0.09	120	10	50
	600	2.3	0.08	145	20	30
	750	1.9	0.07	145	25	30
	900	1.6	0.06	145	30	30
	1200	1.2	0.04	124	30	40
	1500	0.93	0.04	145	50	30
	1800	0.78	0.04	145	60	30
	2400	0.6	0.03	124	60	40
	3000	0.5	0.02	120	60	50
NRV 030/063	4000	0.35	0.02	82	50	80
	4800	0.29	0.02	82	60	80
	300	4.7	0.24	230	7.5	40
	400	3.5	0.19	230	10	40
	500	2.8	0.15	216	10	50
	600	2.3	0.13	230	15	40
	750	1.9	0.11	216	15	50
	900	1.6	0.09	198	15	60
	1200	1.2	0.08	230	30	40
	1500	0.93	0.06	216	30	50
	1800	0.78	0.05	198	30	60
	2400	0.58	0.05	230	60	40
NRV 040/075	3000	0.47	0.04	216	60	50
	4000	0.35	0.03	172	50	80
	5000	0.28	0.02	150	50	100
	300	4.7	0.36	390	10	30
	400	3.5	0.27	360	10	40
	500	2.8	0.21	320	10	50
	600	2.3	0.19	390	20	30
	750	1.9	0.16	390	25	30
	900	1.6	0.14	390	30	30
	1200	1.2	0.11	360	30	40
	1500	0.93	0.1	390	50	30
	1800	0.78	0.09	390	60	30
NRV 040/090	2400	0.58	0.07	360	60	40
	3000	0.47	0.05	320	60	50
	4000	0.35	0.04	250	50	80
	5000	0.28	0.03	230	50	100
	300	4.7	0.56	610	7.5	40
	400	3.5	0.43	610	10	40
	500	2.8	0.34	560	10	50
	600	2.3	0.3	610	15	40
	750	1.9	0.23	560	15	50
	900	1.6	0.19	505	15	60
	1200	1.2	0.17	610	30	40
	1500	0.93	0.14	560	30	50
NRV 050/110	1800	0.78	0.11	505	30	60
	2400	0.58	0.11	610	60	40
	3000	0.47	0.08	560	60	50
	4000	0.35	0.08	460	50	80
	5000	0.28	0.06	410	50	100
	300	4.7	0.95	1100	10	30
	400	3.5	0.69	1030	10	40
	500	2.8	0.56	1000	10	50
	600	2.3	0.48	1030	15	40
	750	1.9	0.43	1100	25	30
	900	1.6	0.38	1100	30	30
	1200	1.2	0.27	1030	30	40
NRV 063/130	1500	0.93	0.28	1100	50	30
	1800	0.78	0.23	1100	60	30
	2400	0.58	0.17	1030	60	40
	3000	0.47	0.14	1000	60	50
	4000	0.35	0.12	780	50	80
	5000	0.28	0.09	710	50	100
	300	4.7	1.48	1760	10	30
	400	3.5	1.09	1650	10	40
	500	2.8	0.86	1550	10	50
	600	2.3	0.76	1650	15	40
	750	1.9	0.66	1760	25	30
	900	1.6	0.58	1760	30	20
NRV 063/130	1200	1.2	0.43	1650	30	40
	1500	0.93	0.39	1760	50	30
	1800	0.78	0.35	1760	60	20
	2400	0.58	0.25	1650	60	40
	3000	0.47	0.2	1550	60	50
	4000	0.35	0.15	1220	50	80
	5000	0.28	0.11	1100	50	100



NMRV–NMRV参数表 Performance table

型号 Type	i	n2	P1 kW1	M2 (Nm)
NMRV030/040	300	4.7	0.09	88
	400	3.5	0.06	70
	500	2.8	0.06	96
	600	2.3	0.06	104
	750	1.9	0.06	121
	900	1.6	0.06	139
	1200	1.2	0.06	166
	1500	0.9	0.06	196
	1800	0.8	0.06	218
	2400	0.58	0.06	261
	3000	0.4	0.06	300
	5000	0.28	0.06	338
NMRV030/050	300	4.7	0.12	119
	400	3.5	0.12	142
	500	2.8	0.12	164
	600	2.3	0.09	159
	750	1.9	0.09	185
	900	1.6	0.09	212
	1200	1.2	0.06	169
	1500	0.93	0.06	199
	1800	0.78	0.06	222
	2400	0.6	0.06	266
	3000	0.5	0.06	307
	4000	0.35	0.06	288
NMRV030/063	4800	0.29	0.06	311
	300	4.7	0.22	210
	400	3.5	0.22	271
	500	2.8	0.18	257
	600	2.3	0.12	208
	750	1.9	0.12	241
	900	1.6	0.09	200
	1200	1.2	0.09	263
	1500	0.93	0.09	305
	1800	0.78	0.06	225
	2400	0.58	0.06	276
	3000	0.47	0.06	319
NMRV040/075	4000	0.35	0.06	306
	5000	0.28	0.06	360
	300	4.7	0.37	405
	400	3.5	0.37	498
	500	2.8	0.25	384
	600	2.3	0.18	362
NMRV040/090	750	1.9	0.18	435
	900	1.6	0.18	487
	1200	1.2	0.12	399
	1500	0.93	0.09	360
	1800	0.93	0.09	404
	2400	0.78	0.09	496
NMRV040/090	3000	0.58	0.06	377
	4000	0.47	0.06	355
	5000	0.35	0.06	419
	300	2.8	0.37	402
	400	4.7	0.37	523
	500	3.5	0.37	611
NMRV050/110	600	2.8	0.37	757
	750	2.3	0.25	598
	900	1.9	0.25	667
	1200	1.6	0.18	629
	1500	1.2	0.18	735
	1800	0.93	0.12	547
	2400	0.78	0.12	695
	3000	0.58	0.09	609
	4000	0.47	0.09	548
	5000	0.35	0.09	431
	300	4.7	0.92	1069
	400	3.5	0.92	1382
NMRV063/130	400	3.5	0.55	826
	500	2.8	0.55	984
	600	2.3	0.55	1181
	750	1.9	0.55	1411
	900	1.6	0.37	1079
	1200	1.2	0.37	1396
	1500	0.93	0.25	1064
	1800	0.78	0.25	1195
	2400	0.58	0.18	1113
	3000	0.47	0.12	884
	4000	0.35	0.12	784
	5000	0.28	0.12	928
NMRV063/130	300	4.7	1.5	1789
	400	3.5	1.5	2279
	500	2.8	1.1	1991
	600	2.3	0.75	1631
	750	1.9	0.75	2005
	900	1.6	0.75	2283
	1200	1.2	0.55	2132
	1500	0.93	0.37	1674
	1800	0.78	0.37	1887
	2400	0.58	0.25	1624
	3000	0.47	0.25	1935
	4000	0.35	0.25	2046
	5000	0.28	0.25	2430



NMRV-NMRV外型尺寸 Dimensions

NMRV025-NMRV030

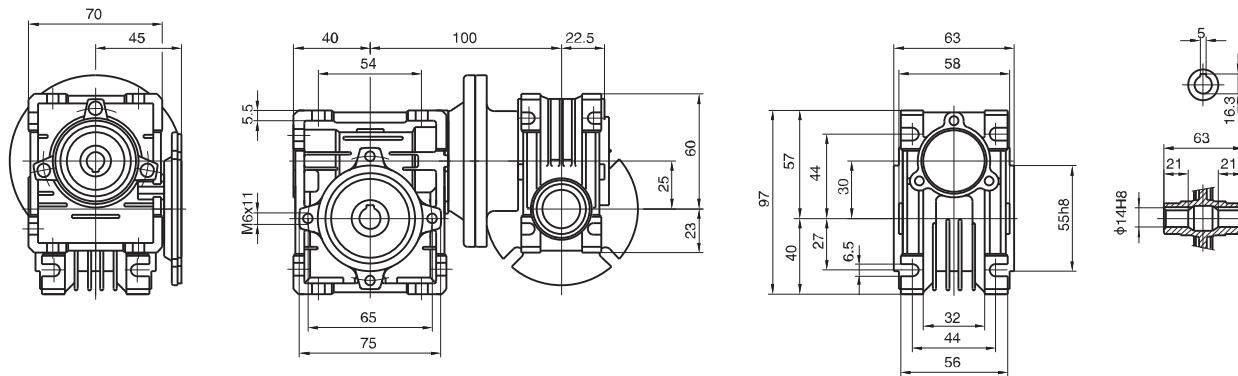

NMRV025-NMRV040

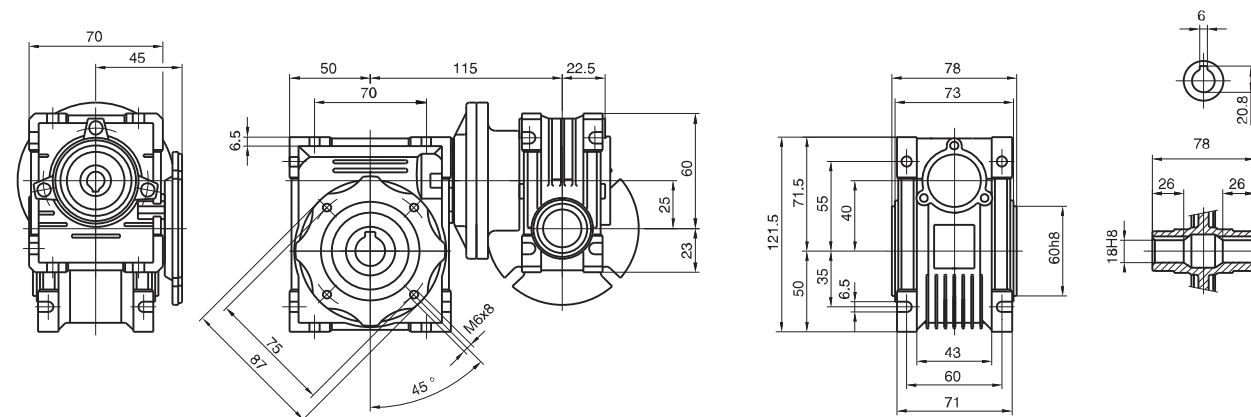

NMRV030-NMRV040

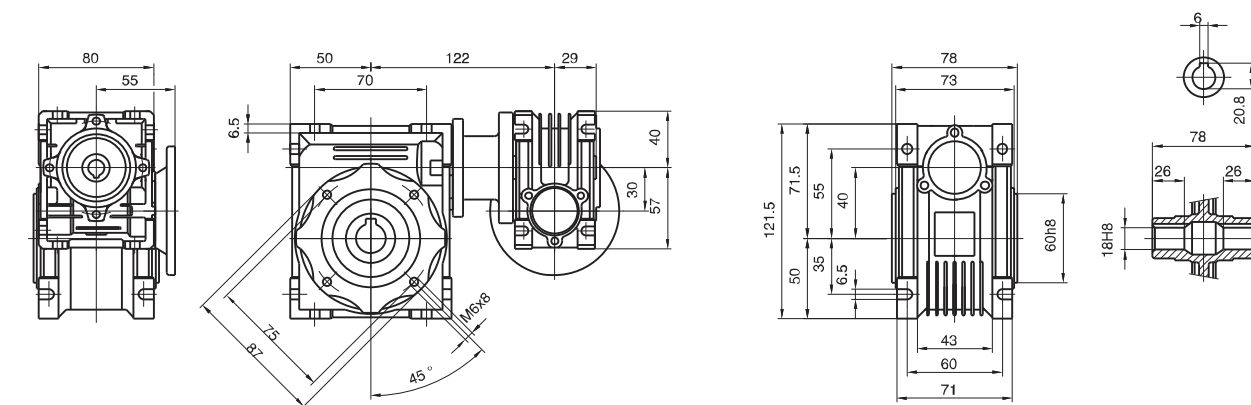

NMRV-NMRV外型尺寸 Dimensions

NMRV030-NMRV050

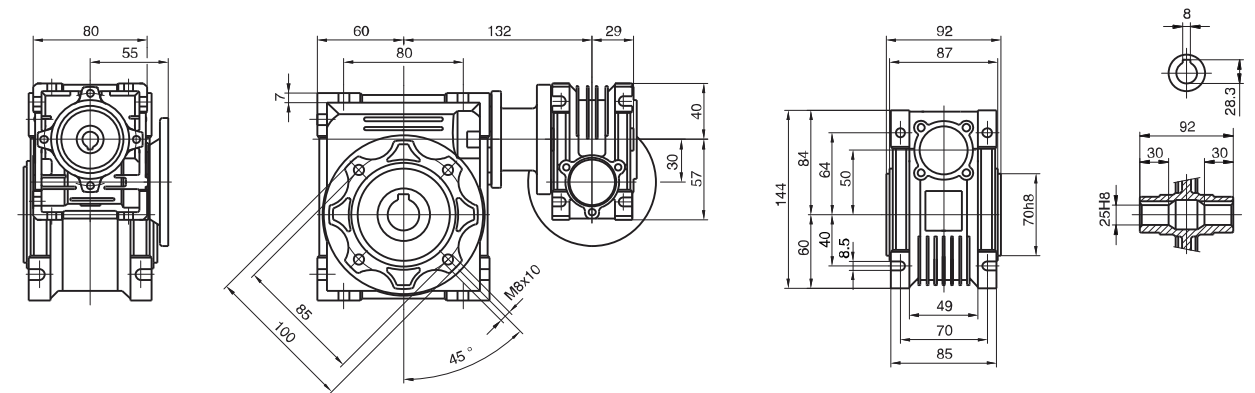

NMRV030-NMRV063

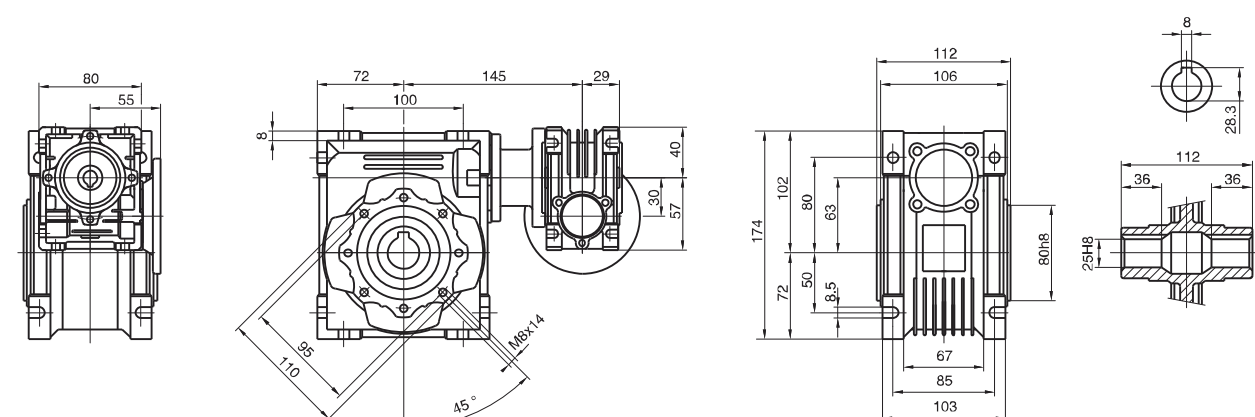

NMRV040-NMRV075

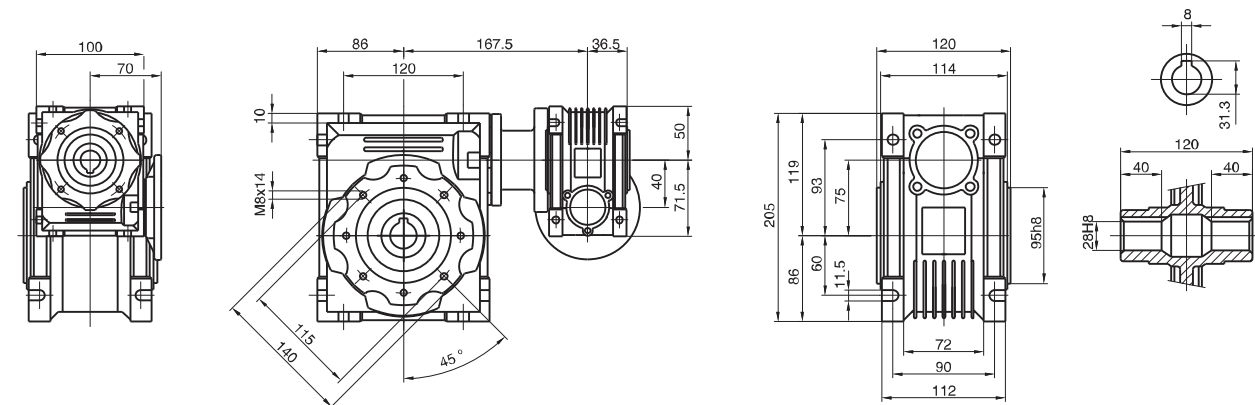



NMRV-NMRV外型尺寸 Dimensions

NMRV040-NMRV090

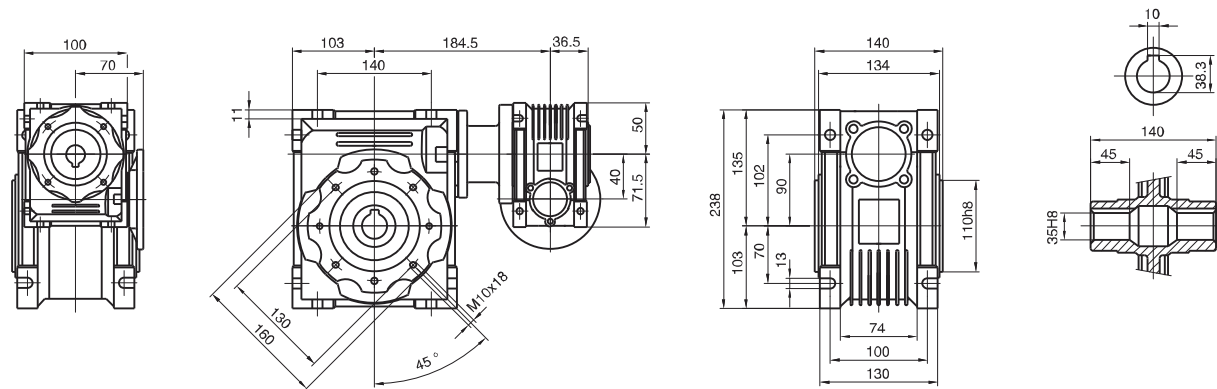

NMRV050-NMRV110

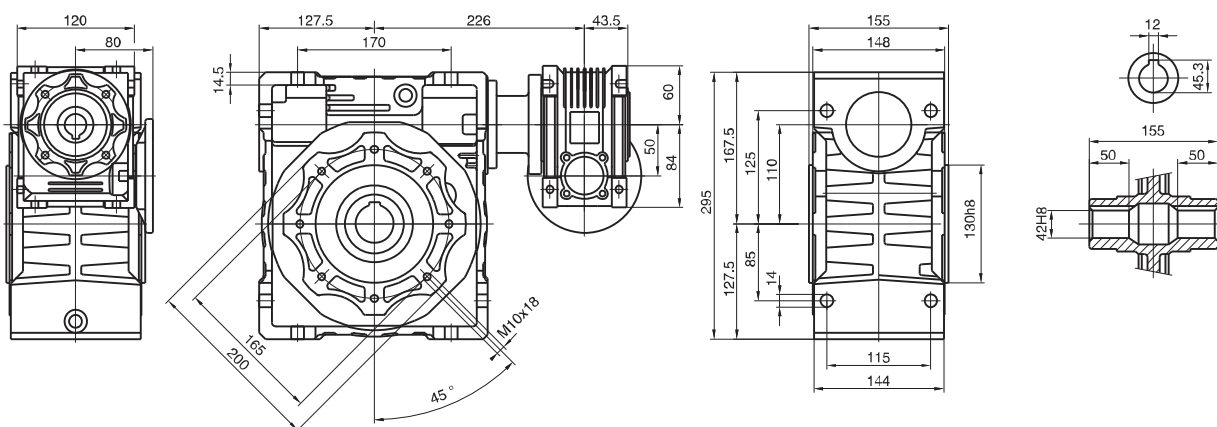

NMRV063-NMRV130

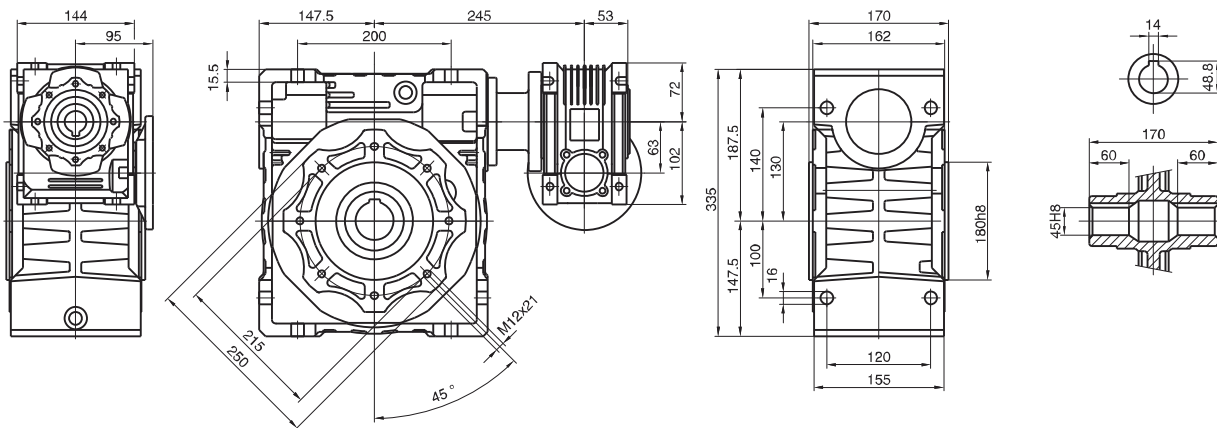

NRV-NMRV外型尺寸 Dimensions

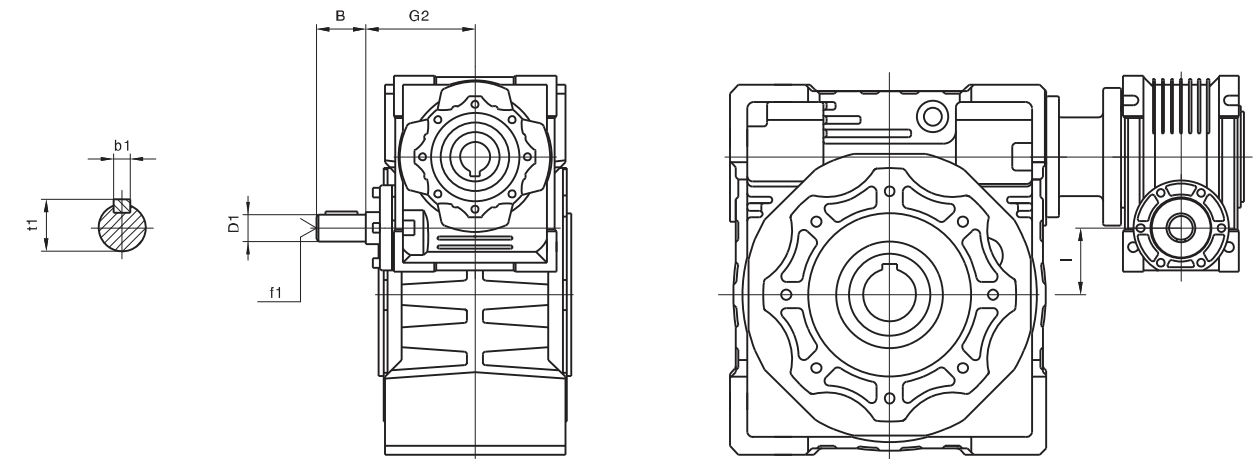

NRV-NMRV	030-040	030-050	030-063	040-075	040-090	050-110	063-130
B	20	20	20	23	23	30	40
D1	9 j6	9 j6	9 j6	11 j6	11 j6	14 j6	19 j6
G2	51	51	51	60	60	74	90
l	10	20	33	35	50	60	67
b1	3	3	3	4	4	5	6
f1	-	-	-	-	-	M6	M6
t1	10.2	10.2	10.2	12.5	12.5	16	21.5



PAM B5外型尺寸 Dimensions

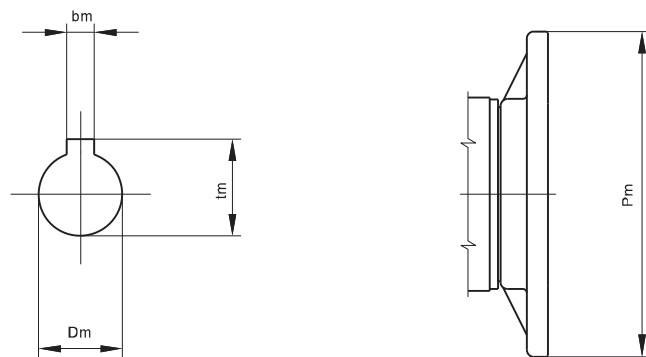

B5	IEC										
	056	063	071	080	090	100	112	132	160	180	200
Pm	120	140	160	200	200	250	250	300	350	350	400
Dm	9	11	14	19	24	28	28	38	42	48	55
bm	3	4	5	6	8	8	8	10	12	14	16
tm	10.4	12.8	16.3	21.8	27.3	31.3	31.3	41.3	45.3	51.8	59.3

PAM B14外型尺寸 Dimensions

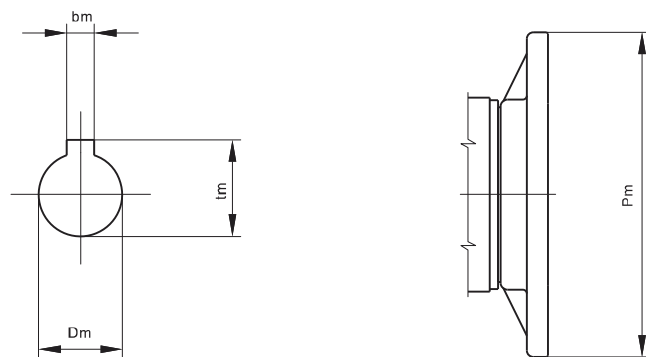

B14	IEC							
	056	063	071	080	090	110	112	132
Pm	80	90	105	120	140	160	160	200
Dm	9	11	14	19	24	28	28	38
bm	3	4	5	6	8	8	8	10
tm	10.4	12.8	16.3	21.8	27.3	31.3	31.3	41.3